



US006063050A

United States Patent [19]

[11] Patent Number: **6,063,050**

Manna et al.

[45] Date of Patent: **May 16, 2000**

[54] **ULTRASONIC DISSECTION AND COAGULATION SYSTEM**

[75] Inventors: **Ronald Manna**, Valley Stream; **Scott Isola**, Deer Park, both of N.Y.; **H. Jonathan Tovey**, Monroe; **Dominick L. Mastri**, Bridgeport, both of Conn.; **Corbett W. Stone**, San Diego, Calif.; **Ernie Aranvi**, Easton, Conn.

[73] Assignees: **United States Surgical Corp.**, Norwalk, Conn.; **Misonix Inc.**, Farmingdale, N.Y.

[21] Appl. No.: **09/174,276**

[22] Filed: **Oct. 16, 1998**

Related U.S. Application Data

- [63] Continuation of application No. 08/911,207, Aug. 14, 1997.
- [51] **Int. Cl.⁷** **A61B 17/20**
- [52] **U.S. Cl.** **604/22; 606/45; 606/169; 601/2**
- [58] **Field of Search** **604/22; 606/37-40; 606/45, 46, 52, 169-171, 174; 601/2**

References Cited

U.S. PATENT DOCUMENTS

2,002,594	5/1935	Wappler et al. .
2,011,169	8/1935	Wappler .
2,714,890	8/1955	Vang .
2,874,470	2/1959	Richards .
3,086,288	4/1963	Balamuth et al. .
3,427,480	2/1969	Robinson .
3,526,219	9/1970	Balamuth .
3,636,943	1/1972	Balamuth .
3,752,161	8/1973	Bent .
3,792,701	2/1974	Kloz et al. .
3,862,630	1/1975	Balamuth .
3,899,829	8/1975	Storm et al. .
3,930,173	12/1975	Banko .
4,428,748	1/1984	Peyman et al. .
4,672,965	6/1987	Baum .
4,682,597	7/1987	Myers .
5,026,387	6/1991	Thomas .

5,047,043	9/1991	Kubota et al. .
5,057,098	10/1991	Zelman .
5,059,210	10/1991	Clark et al. .
5,167,725	12/1992	Clark et al. .
5,180,363	1/1993	Idemoto et al. .
5,188,102	2/1993	Idemoto et al. .

(List continued on next page.)

FOREIGN PATENT DOCUMENTS

0 394 583	10/1990	European Pat. Off. .
2 032 501	1/1972	Germany .
1 232 948	9/1989	Japan .
1-232949	9/1989	Japan .
63-061609	5/1993	Japan .
1155256	5/1985	U.S.S.R. .
WO 86/02257	4/1986	WIPO .
WO 94/20025	9/1994	WIPO .

OTHER PUBLICATIONS

International Search Report, dated Jan. 5, 1998.
U.S. Patent Application Serial No. 08/925,184.

Primary Examiner—John D. Yasko

[57] ABSTRACT

An ultrasonic dissection and coagulation system for surgical use is provided. The system includes an ultrasonic instrument, a control module, and a pedal actuator. The ultrasonic instrument has a housing and an elongated body portion extending from the housing. An ultrasonic transducer supported within the housing is operatively connected to a cutting blade by a vibration coupler. The vibration coupler conducts high frequency vibration from the ultrasonic transducer to the cutting blade. The cutting blade has a cutting surface which is angled with respect to the longitudinal axis of the elongated body portion and, thus, with respect to the axis of vibration. A clamp member having a tissue contact surface is positioned adjacent to the blade member and is movable from an open position in which the tissue contact surface is in close juxtaposed alignment with the cutting surface to clamp tissue therebetween. The clamp member and the angled blade combine to enhance contact between tissue and the cutting surface of the blade member.

12 Claims, 33 Drawing Sheets

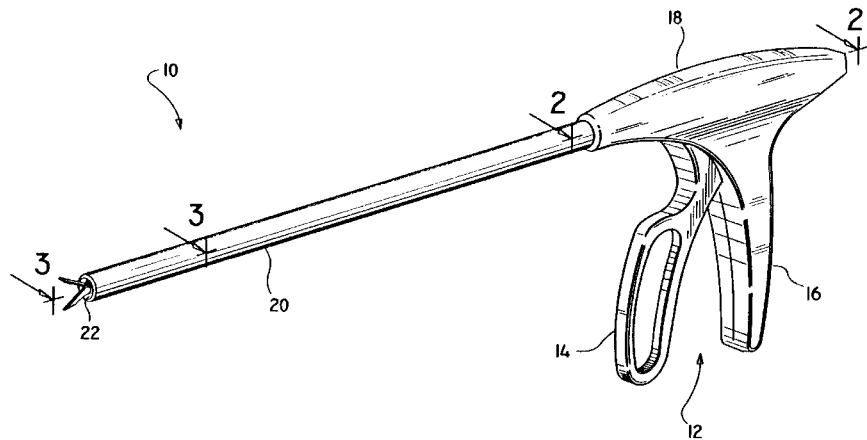

U.S. PATENT DOCUMENTS					
			5,334,183	8/1994	Wuchinich .
			5,352,222	10/1994	Rydell .
			5,389,104	2/1995	Hahnen et al. .
5,190,541	3/1993	Abele et al. .	5,441,512	8/1995	Muller .
5,201,759	4/1993	Ferzli .	5,562,693	10/1996	Devlin et al. .
5,217,460	6/1993	Knoepfler .	5,776,155	7/1998	Beaupre et al. .
5,222,937	6/1993	Kagawa .	5,800,448	9/1998	Banko .
5,263,957	11/1993	Davison .	5,810,859	9/1998	DiMatteo et al. .
5,267,998	12/1993	Hagen .	B1 5,322,055	10/1997	Davison et al. .
5,322,055	6/1994	Davison et al. .			

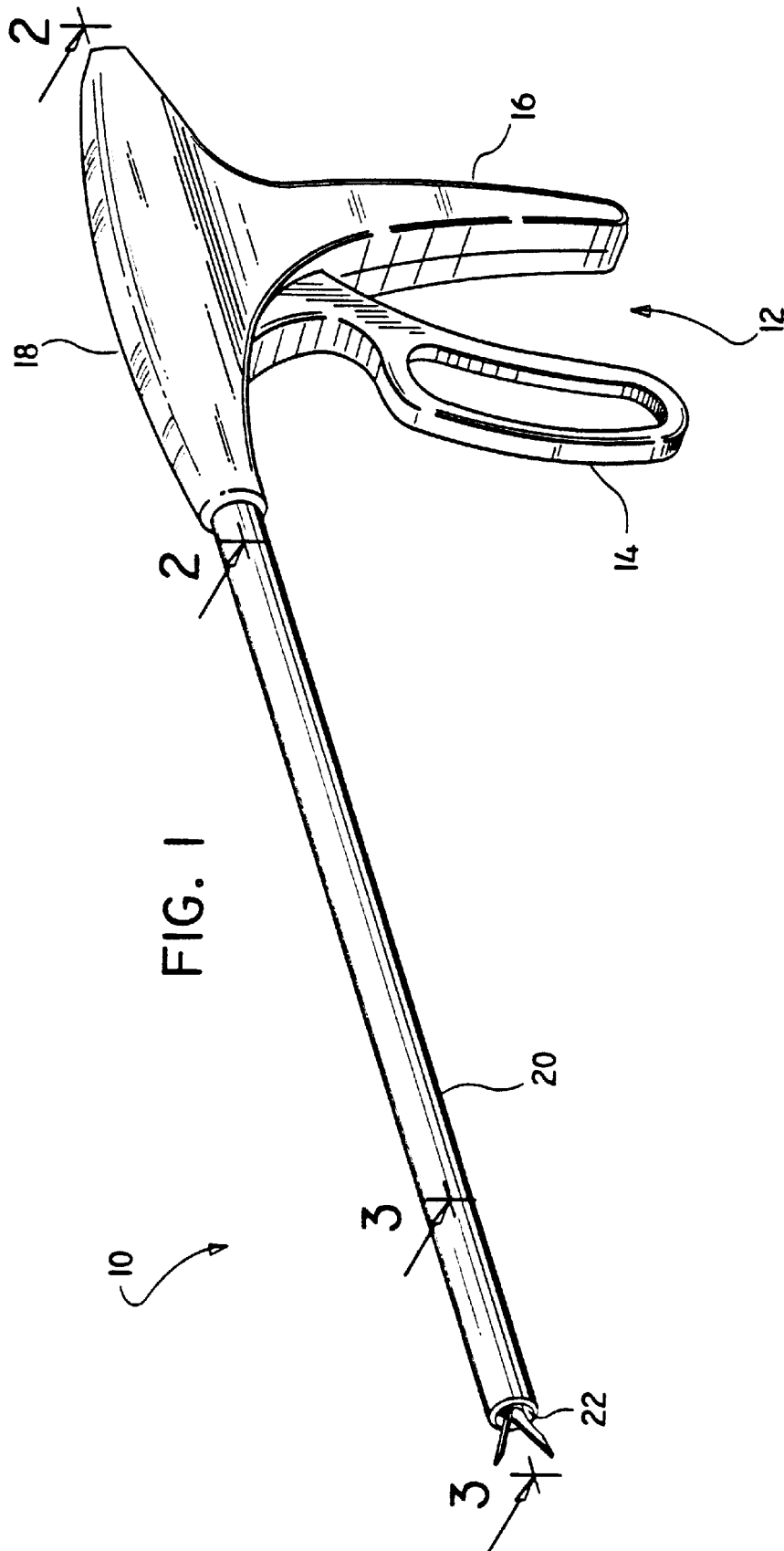

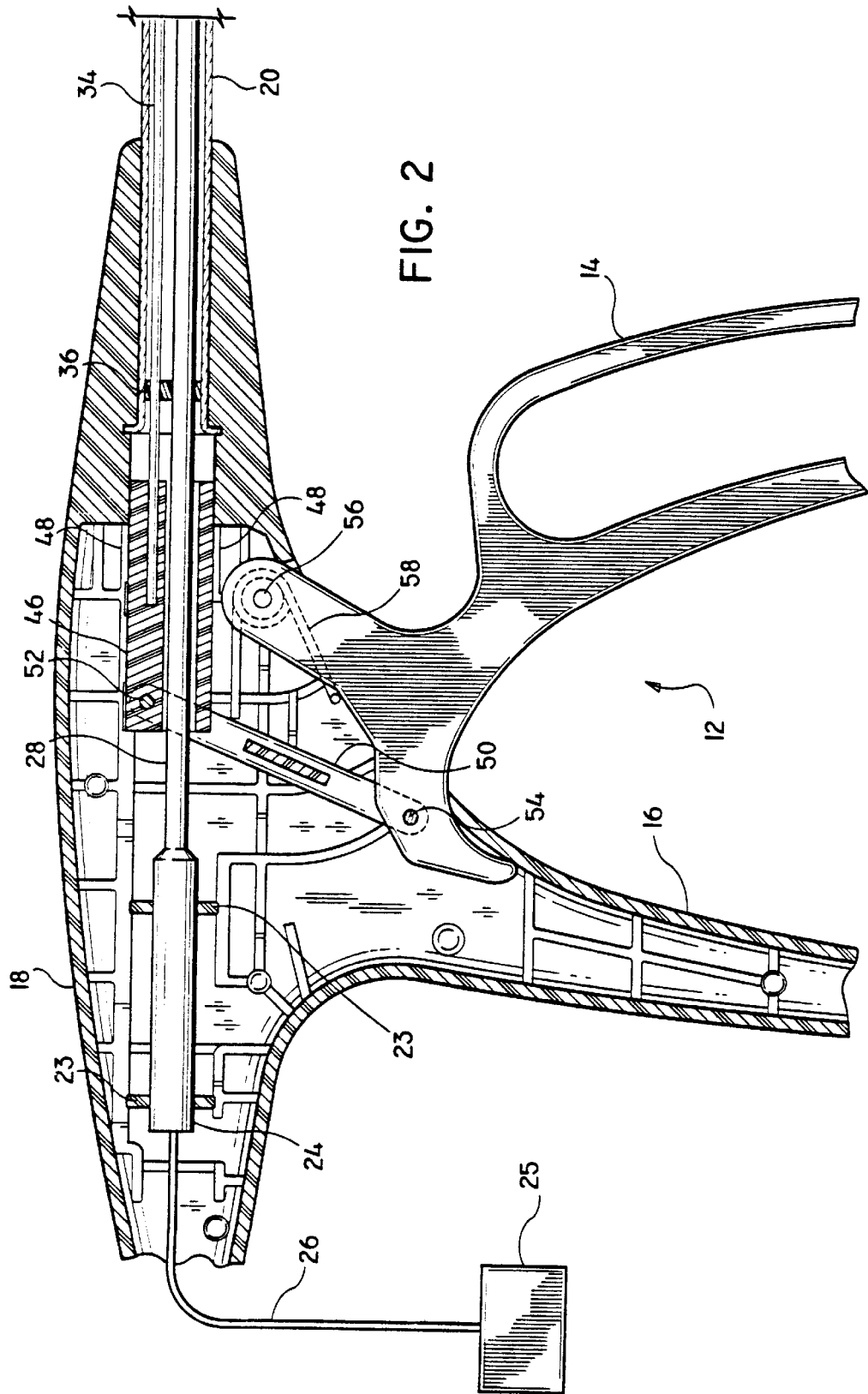

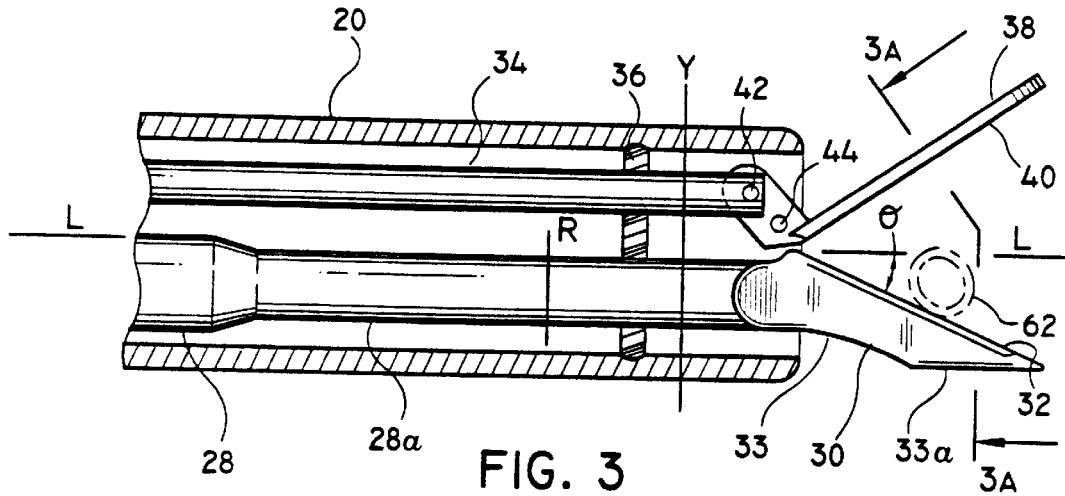

FIG. 3

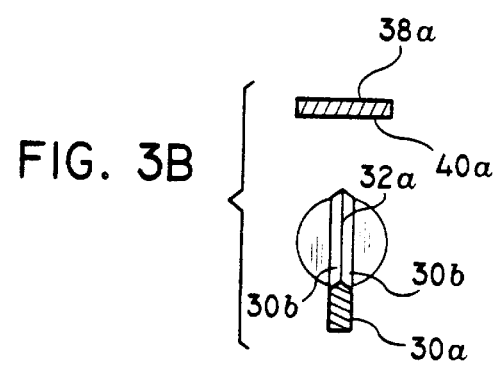

FIG. 3B

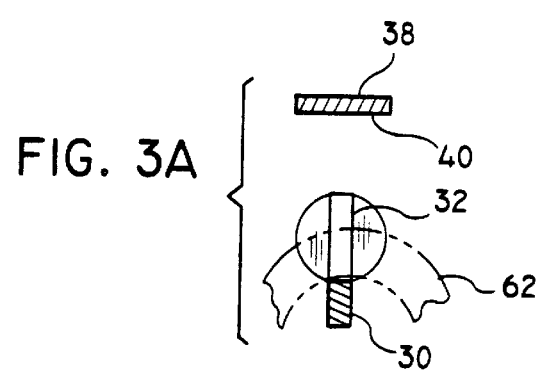
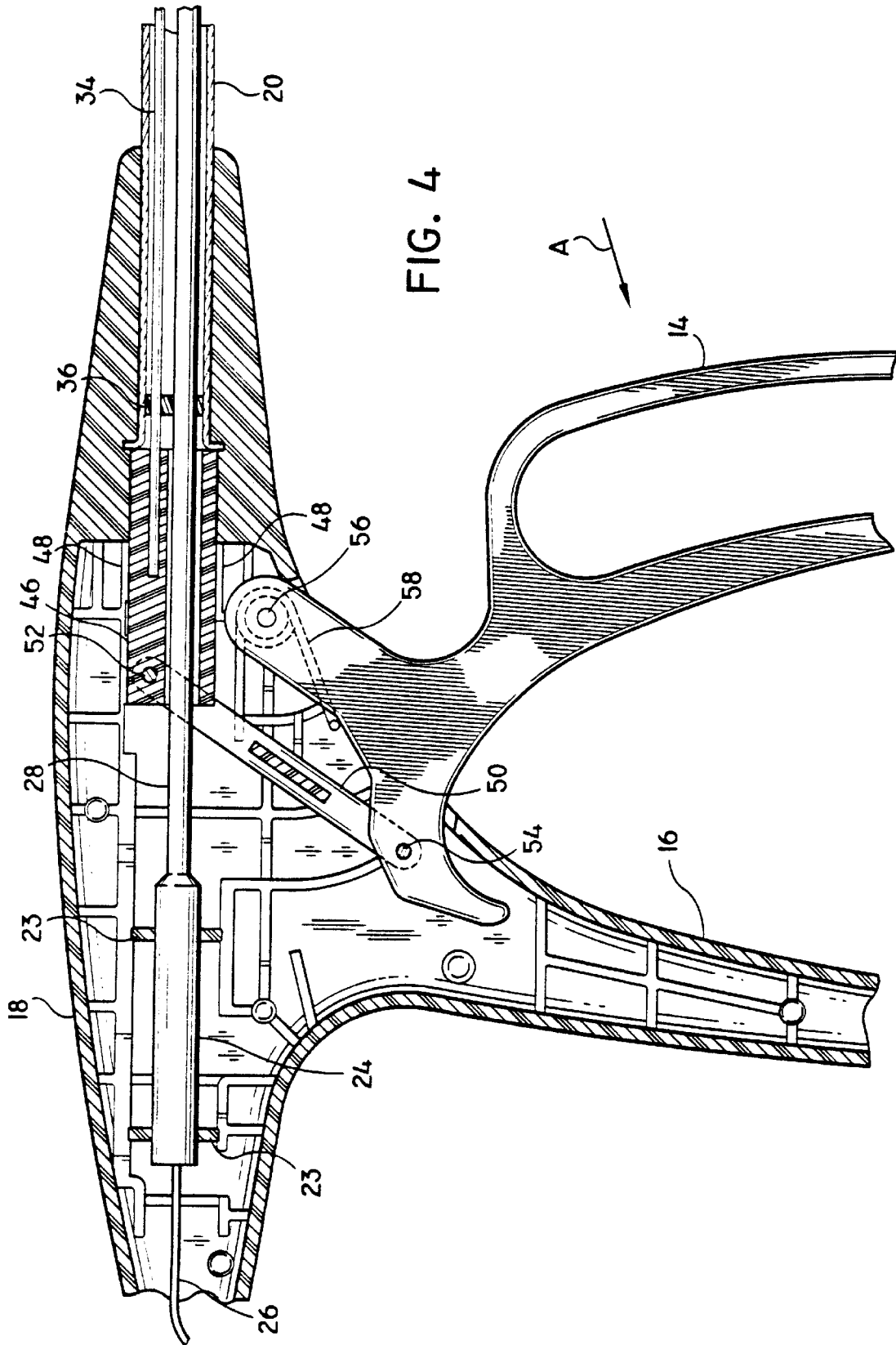

FIG. 3A



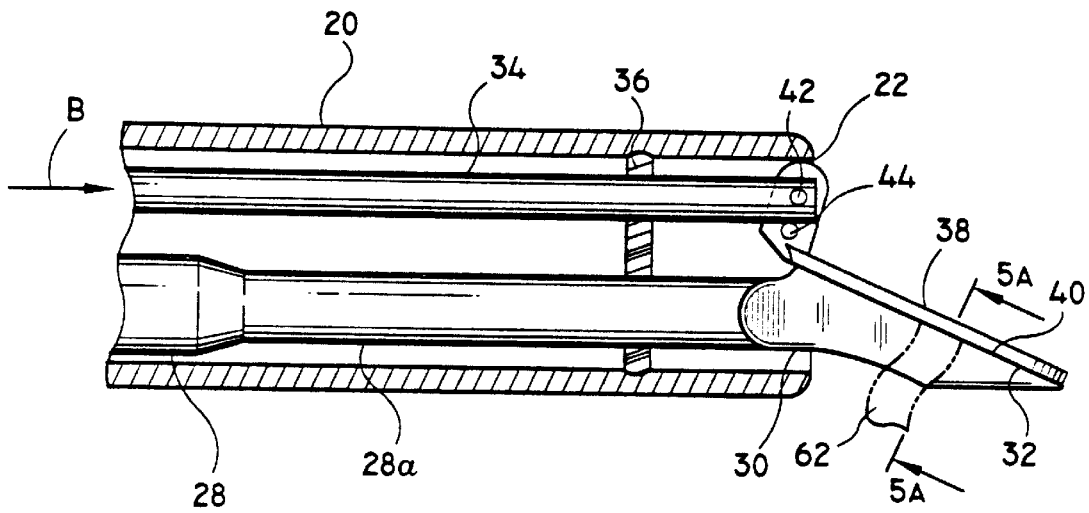

FIG. 5

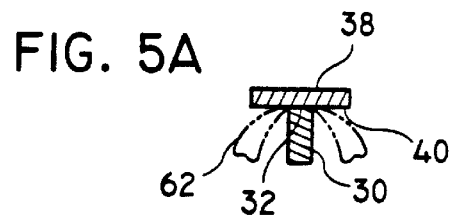
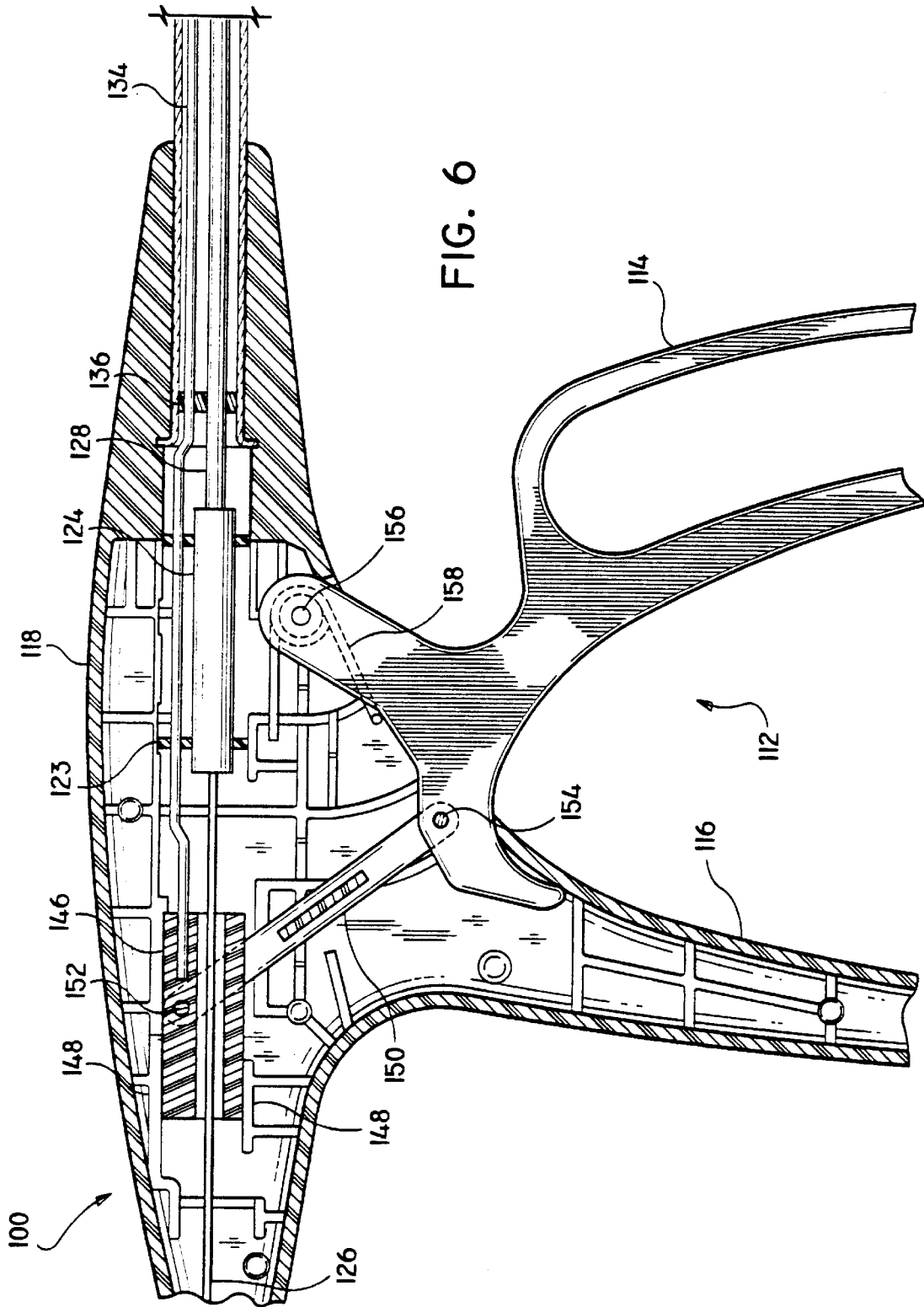

FIG. 5A



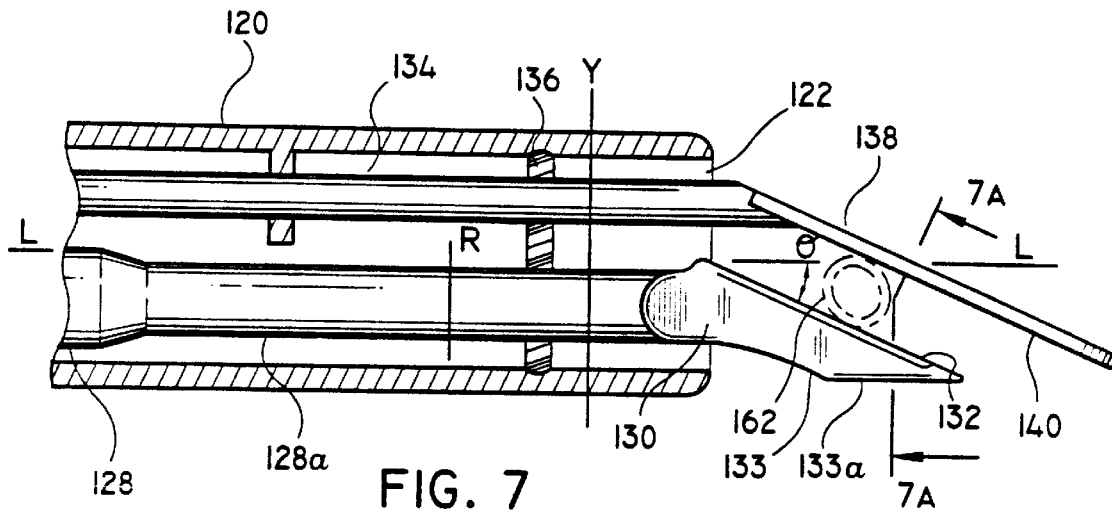

FIG. 7

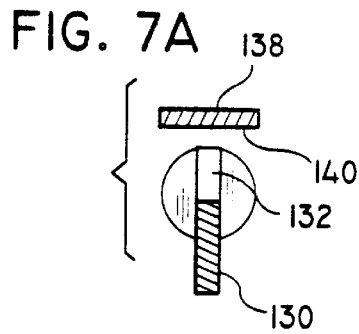

FIG. 7A

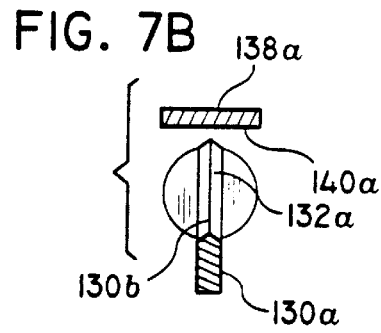

FIG. 7B

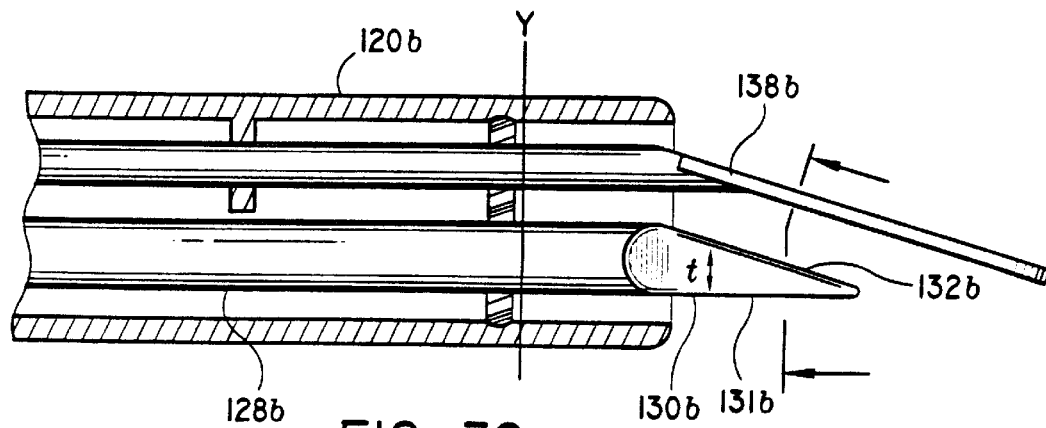
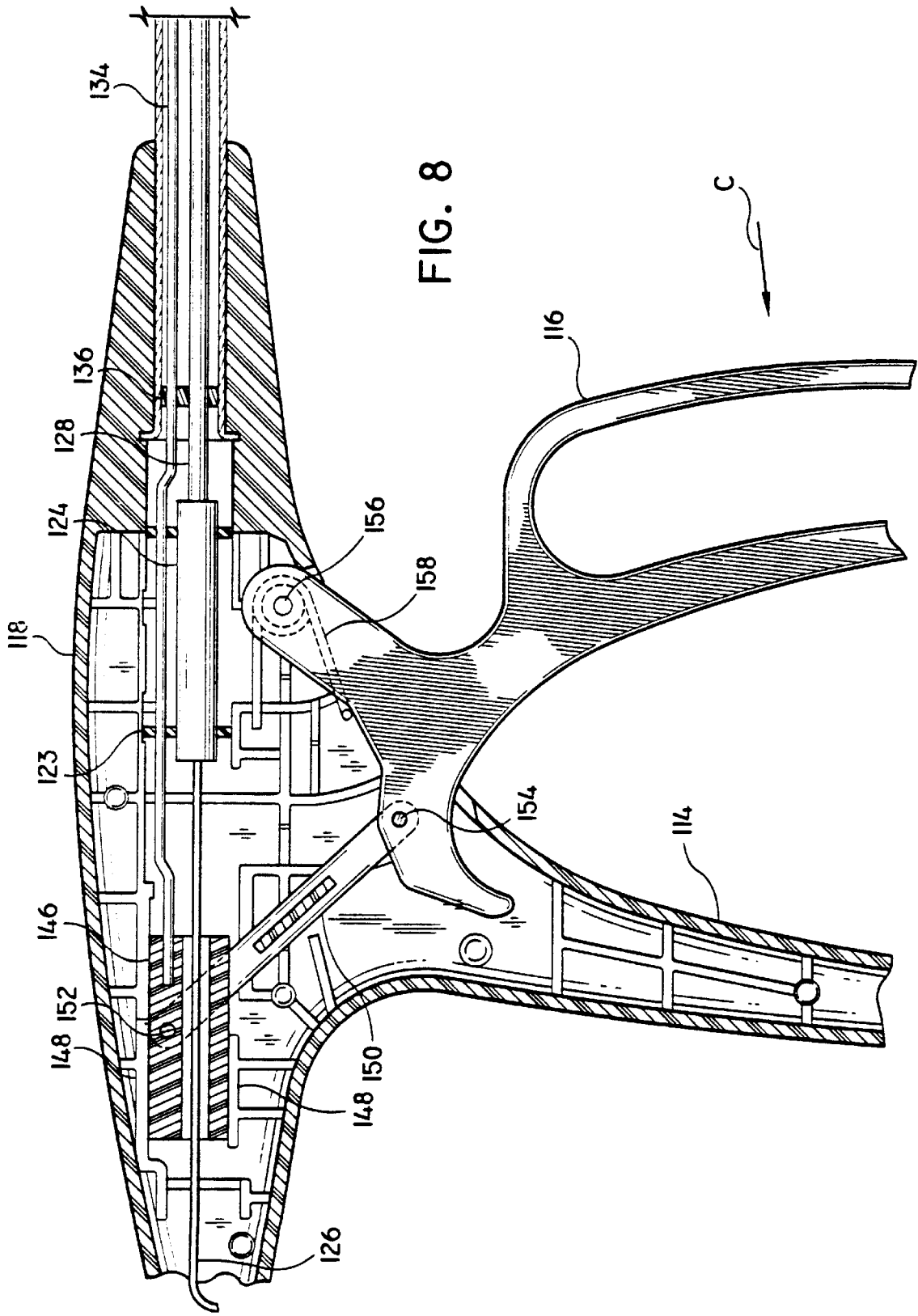

FIG. 7C



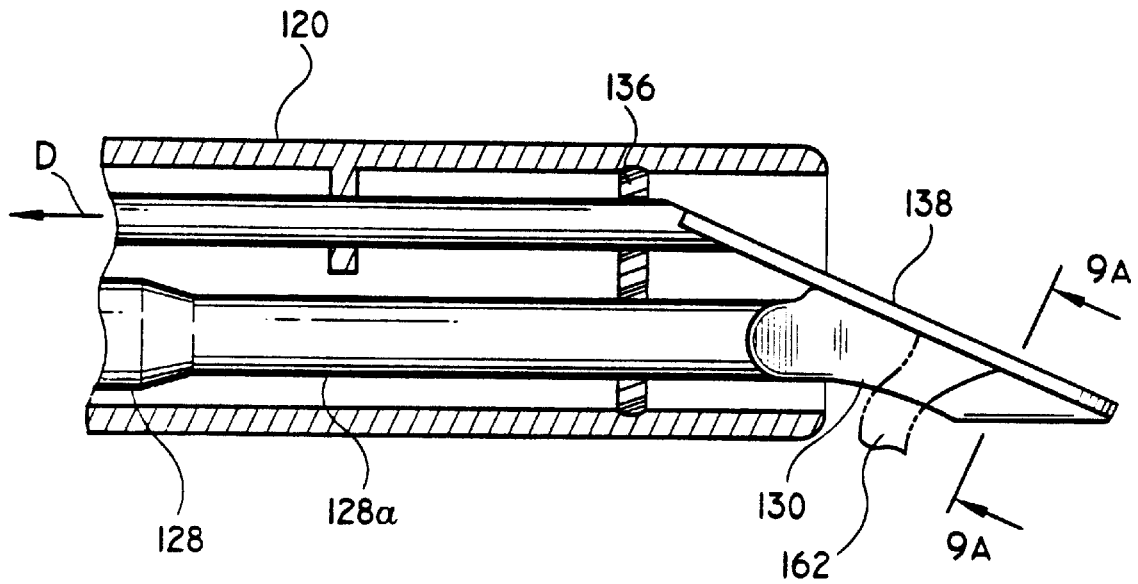
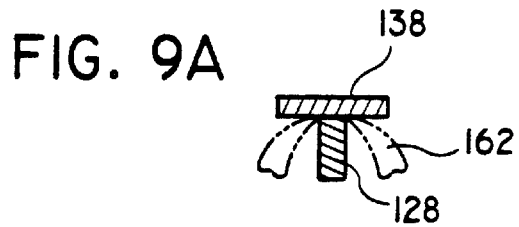

FIG. 9



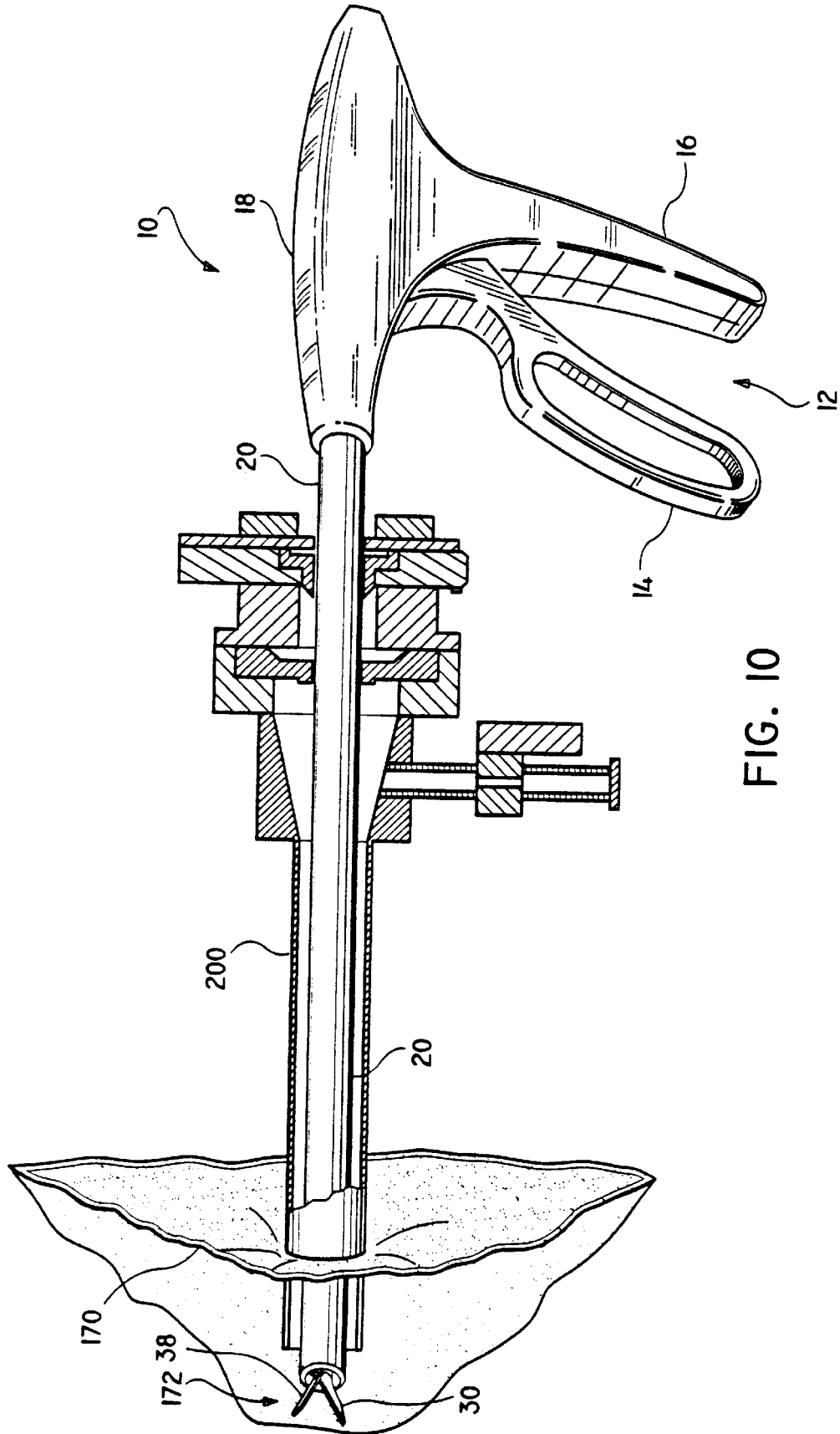

FIG. 10

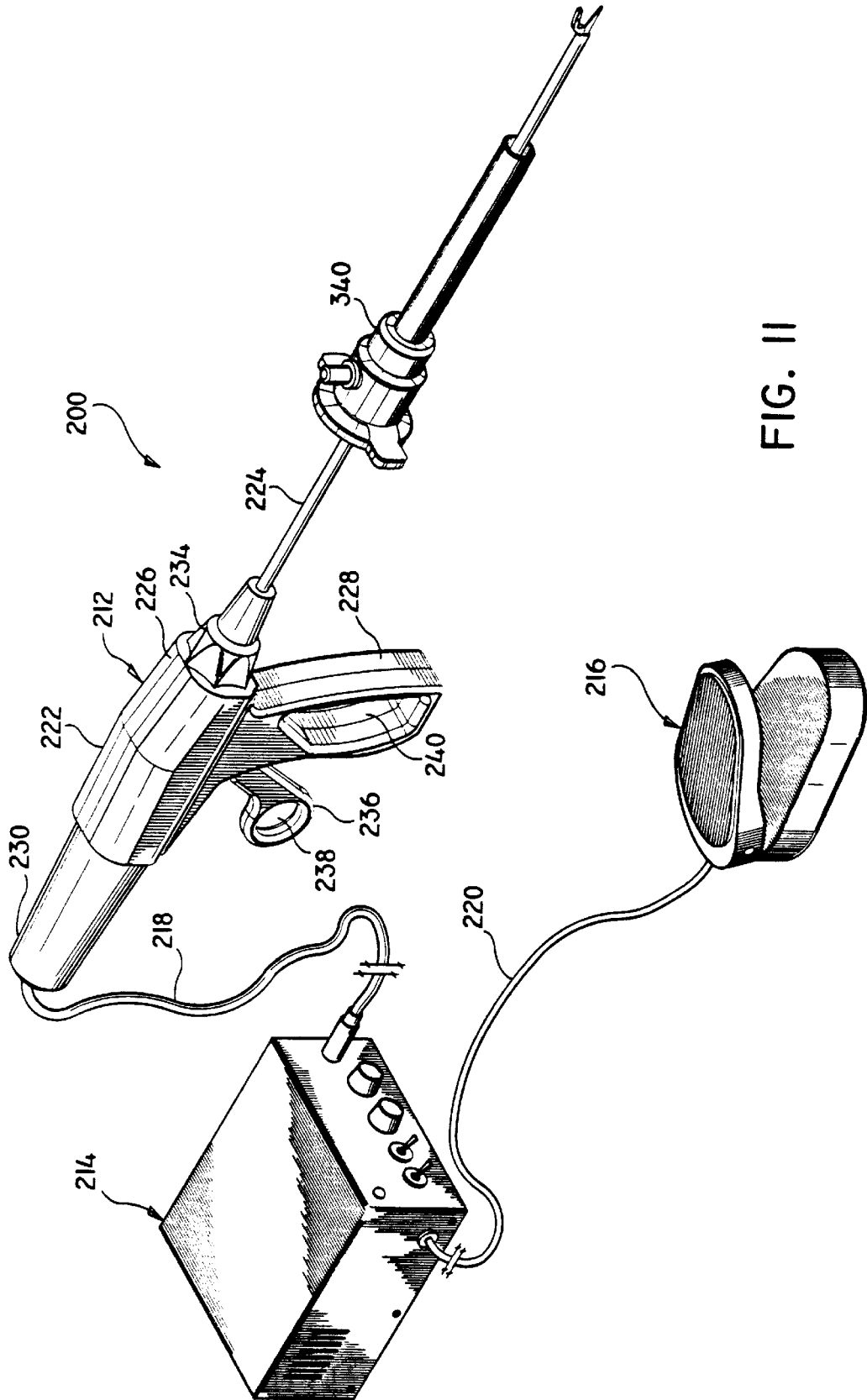

FIG. II

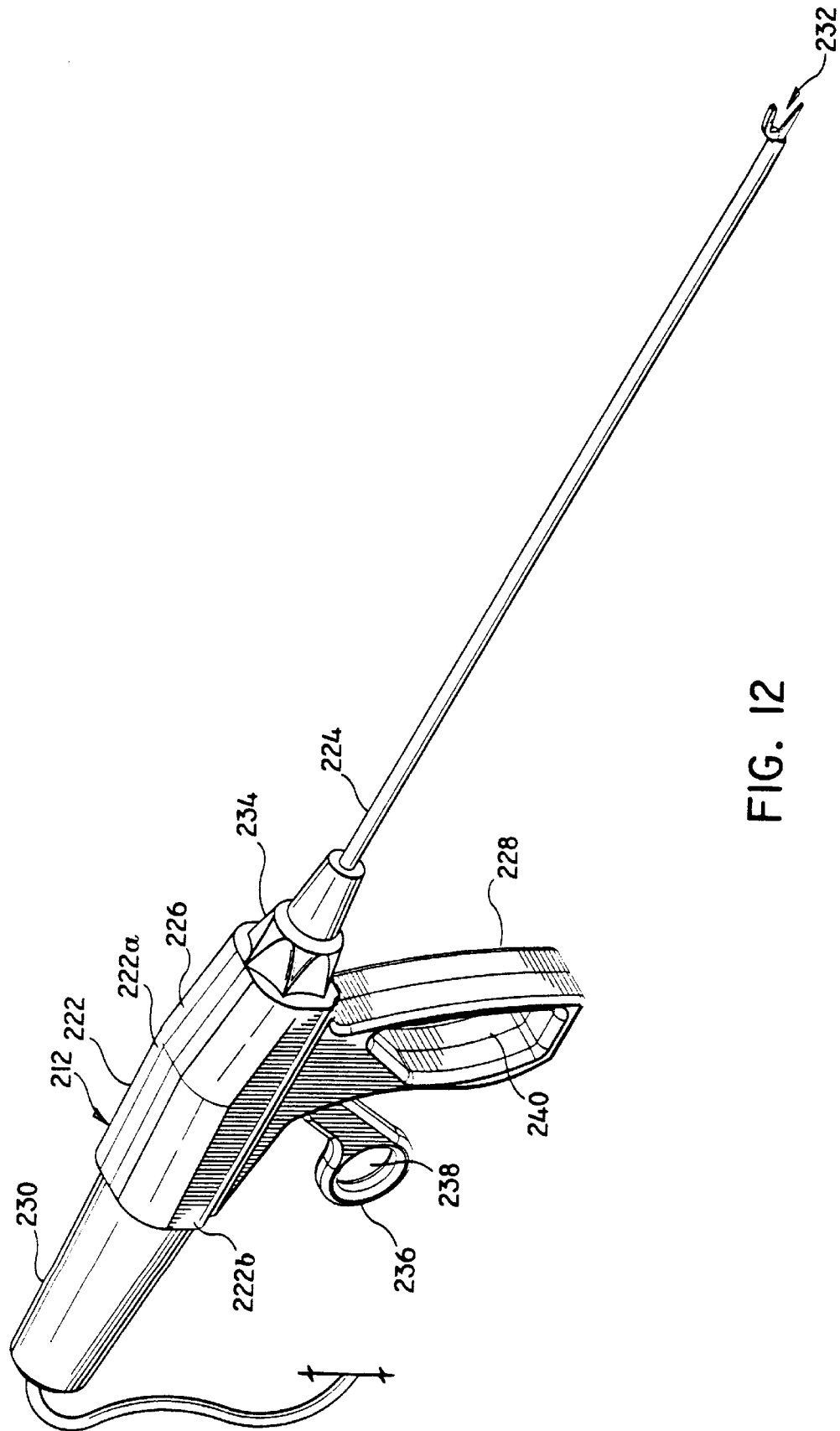

FIG. 12

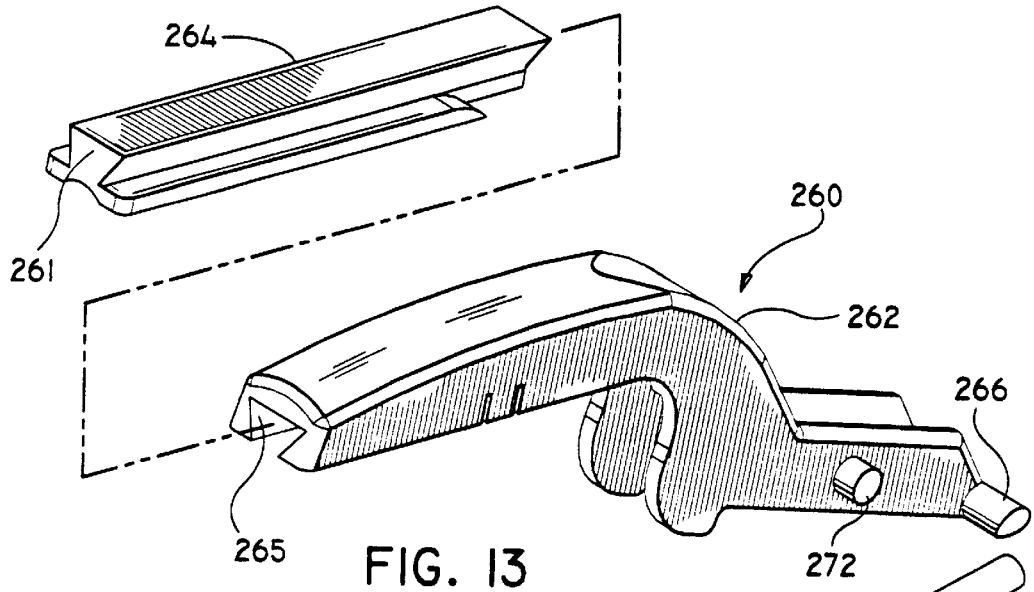

FIG. 13

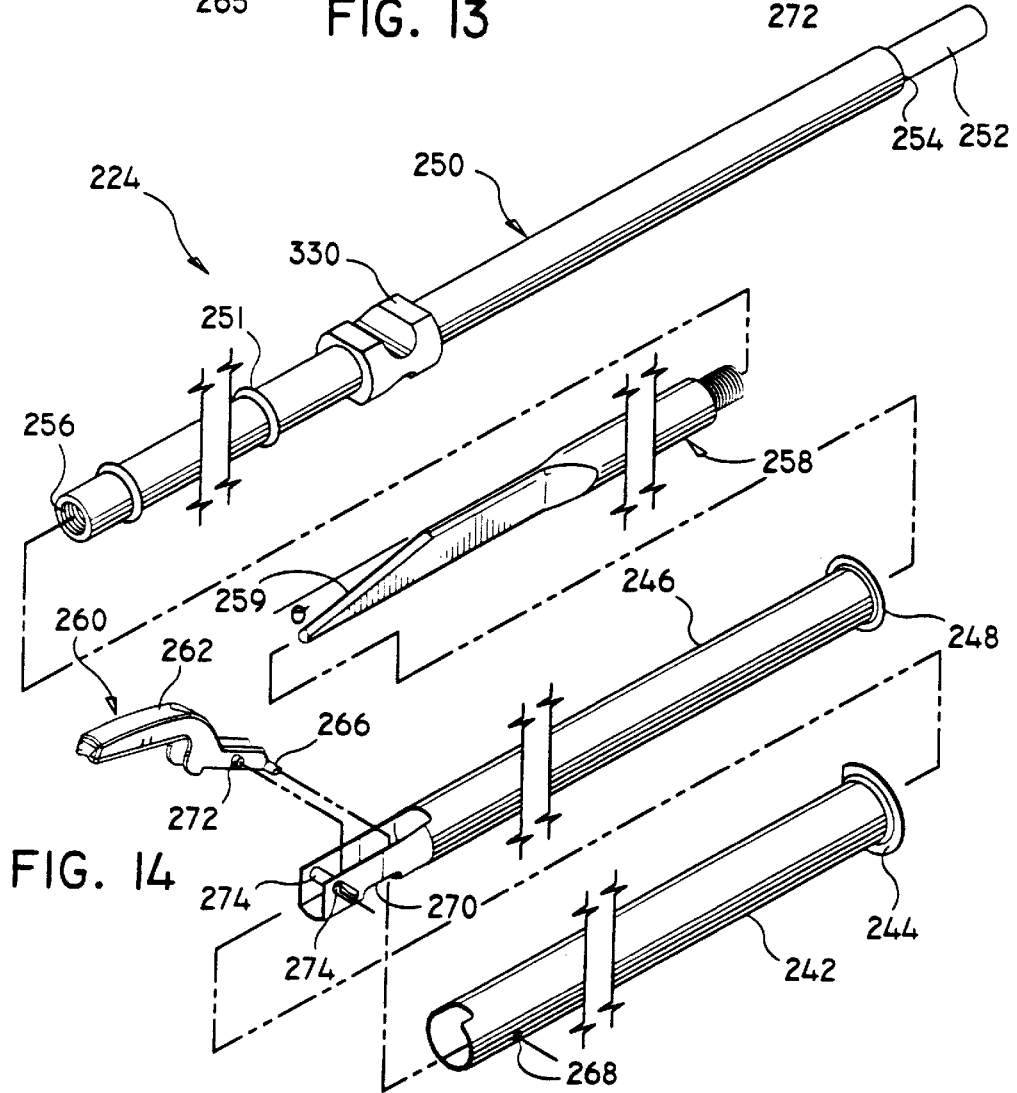

FIG. 14

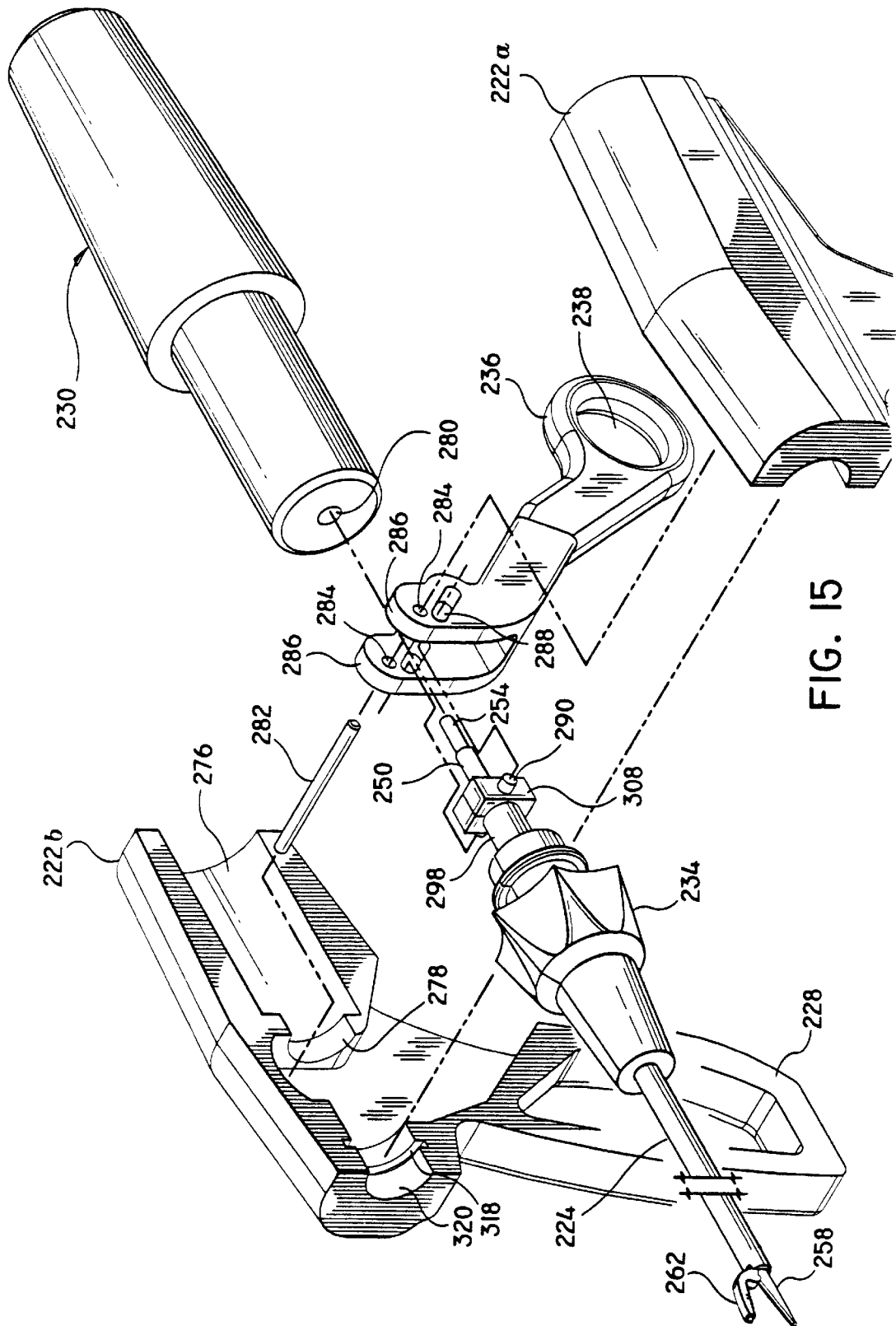

FIG. 15

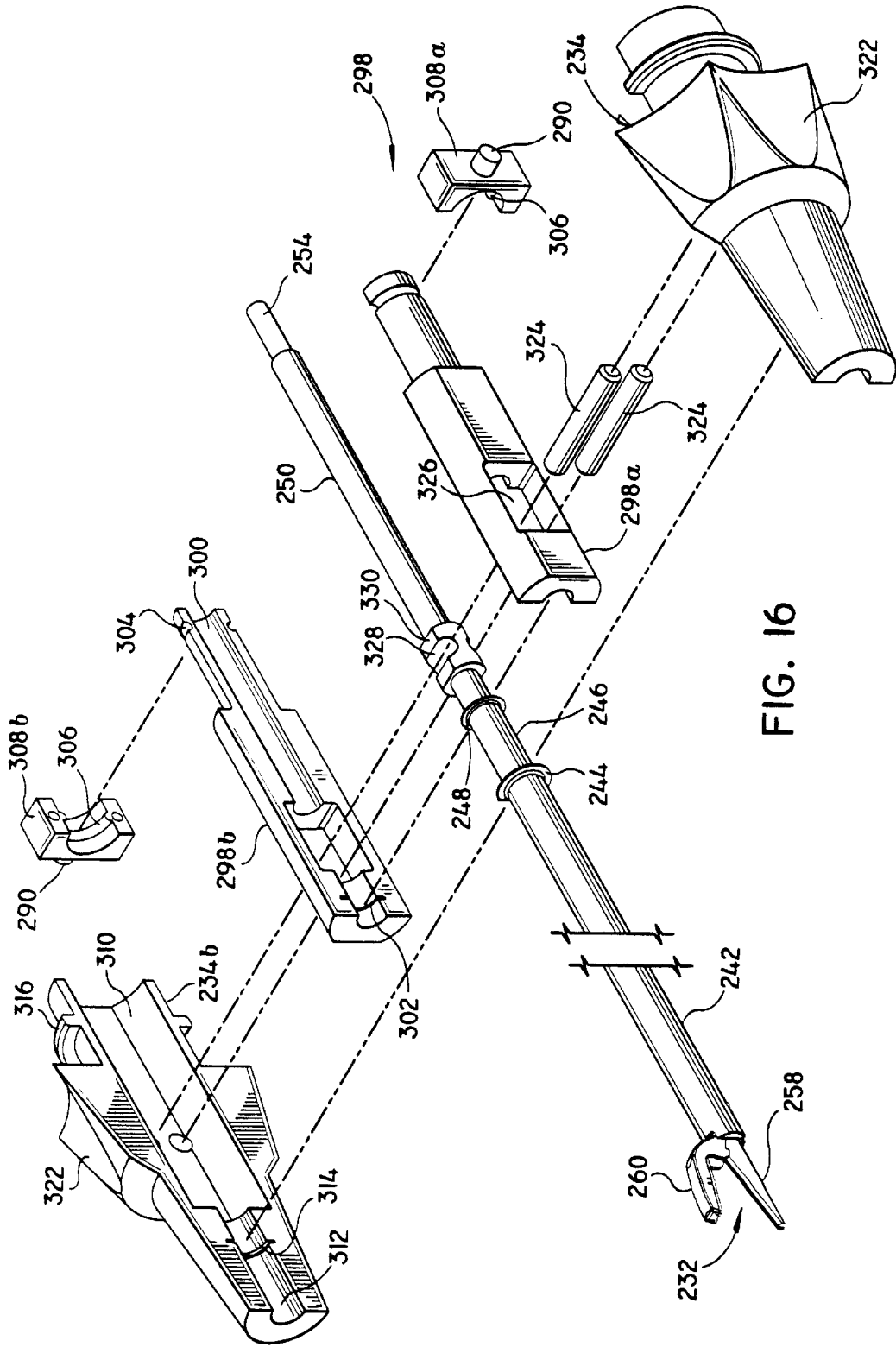

FIG. 16

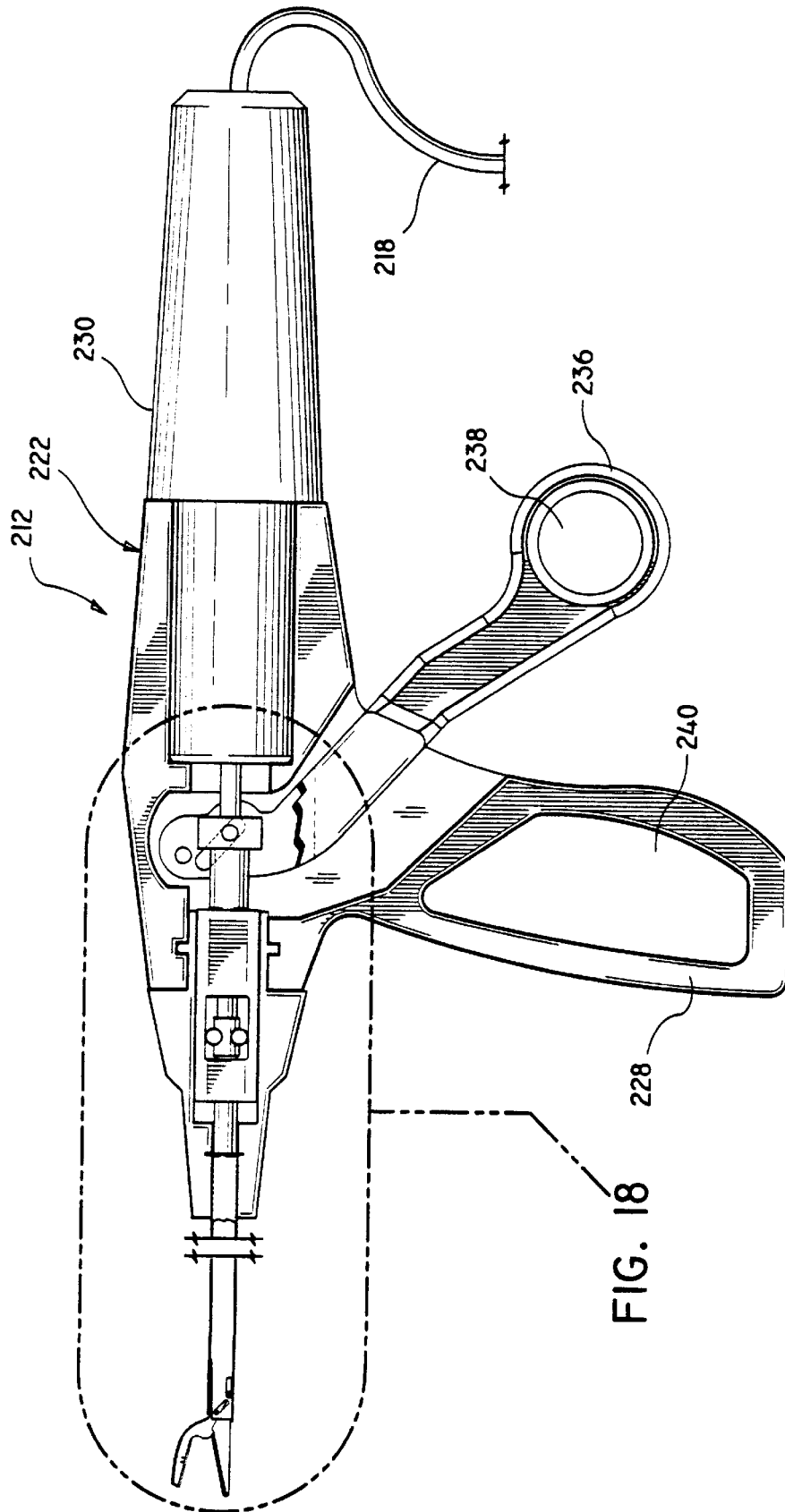
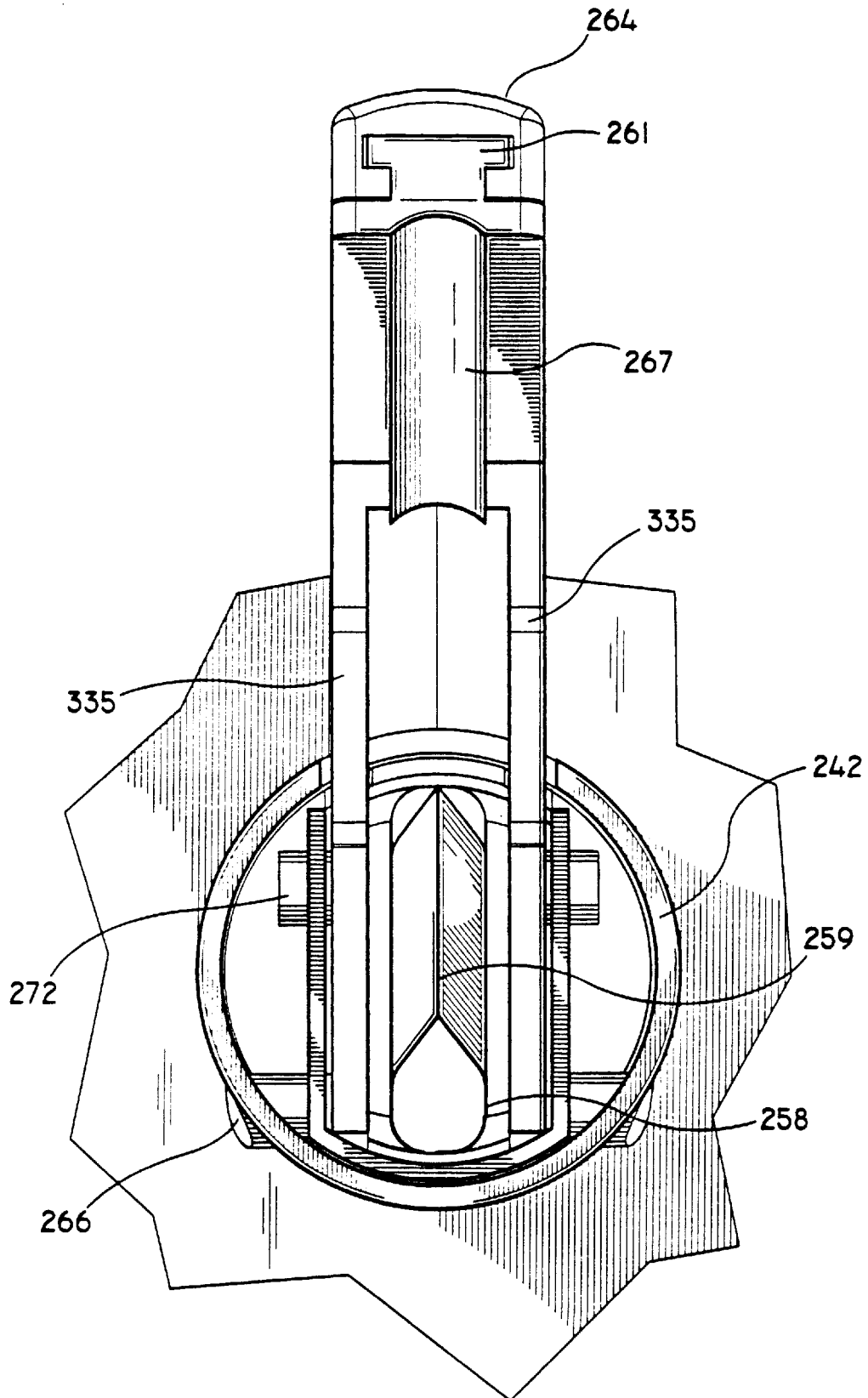

FIG. 17

FIG. 18

FIG. 21



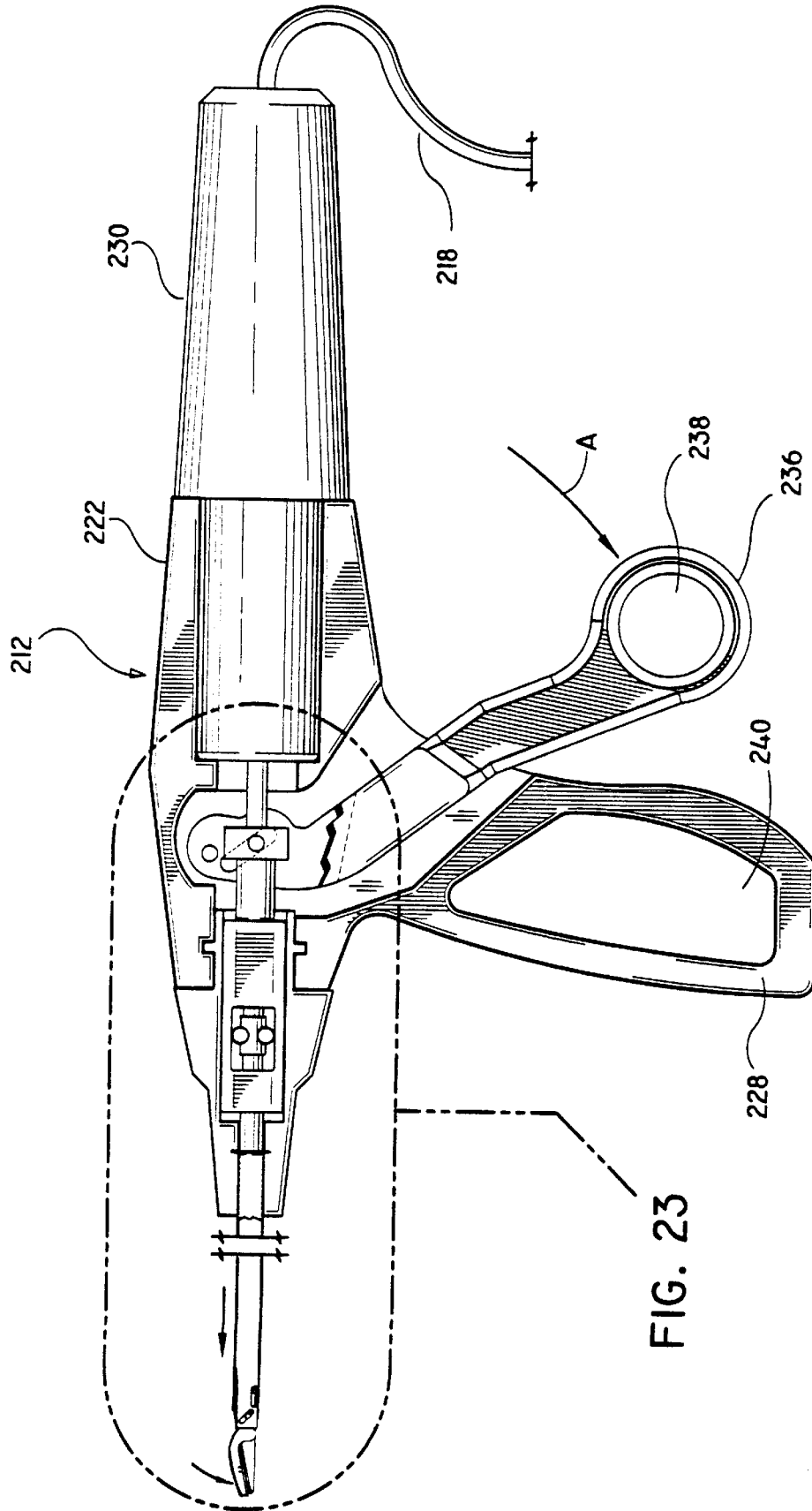

FIG. 22

FIG. 23

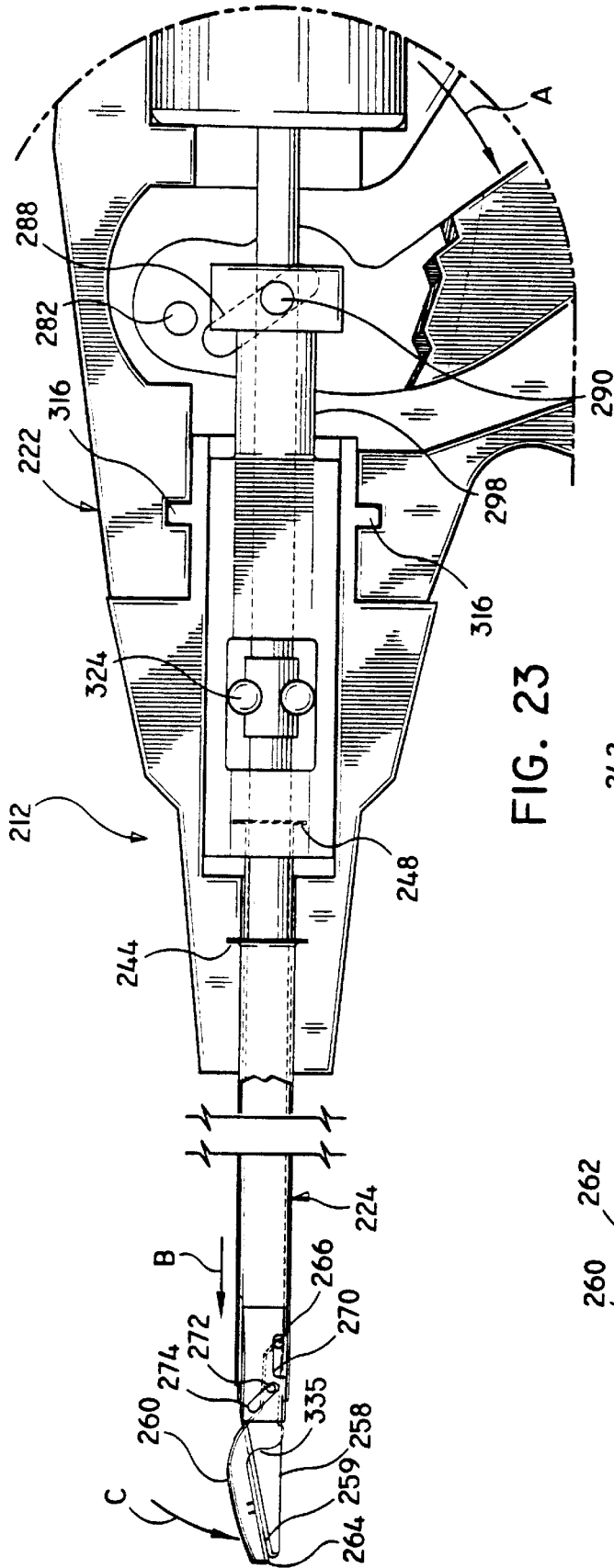

FIG. 23

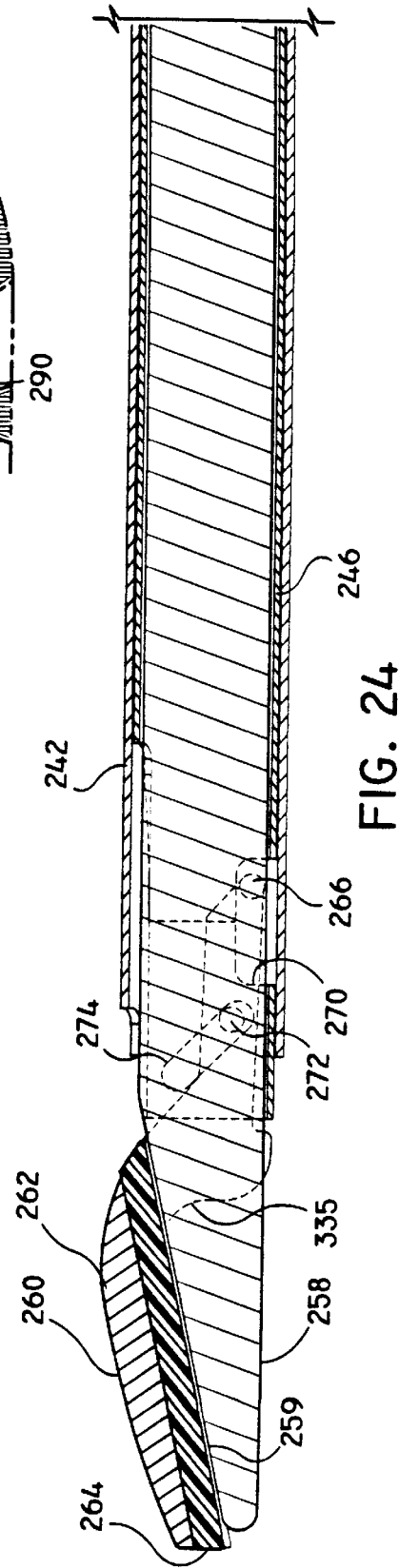

FIG. 24

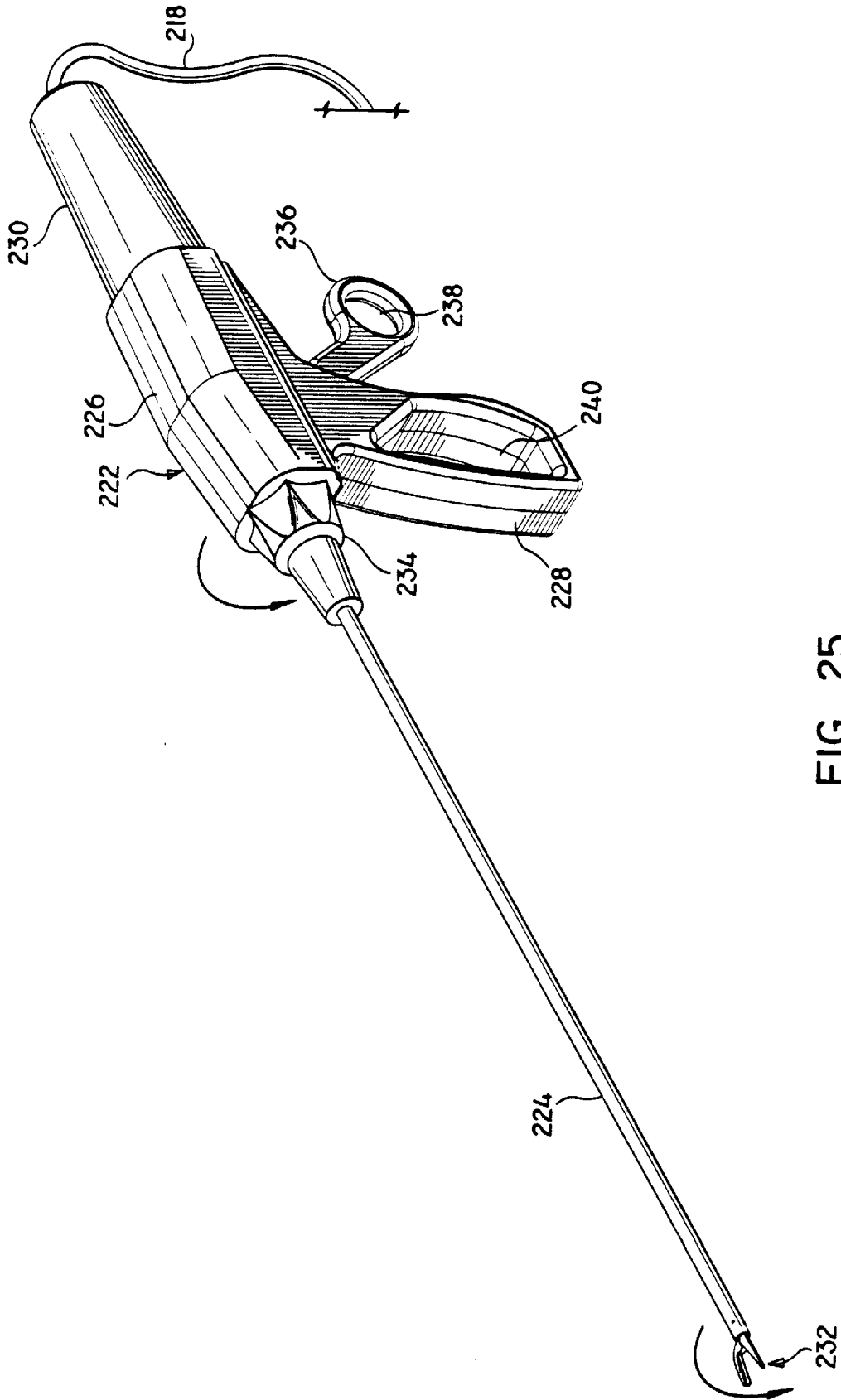

FIG. 25

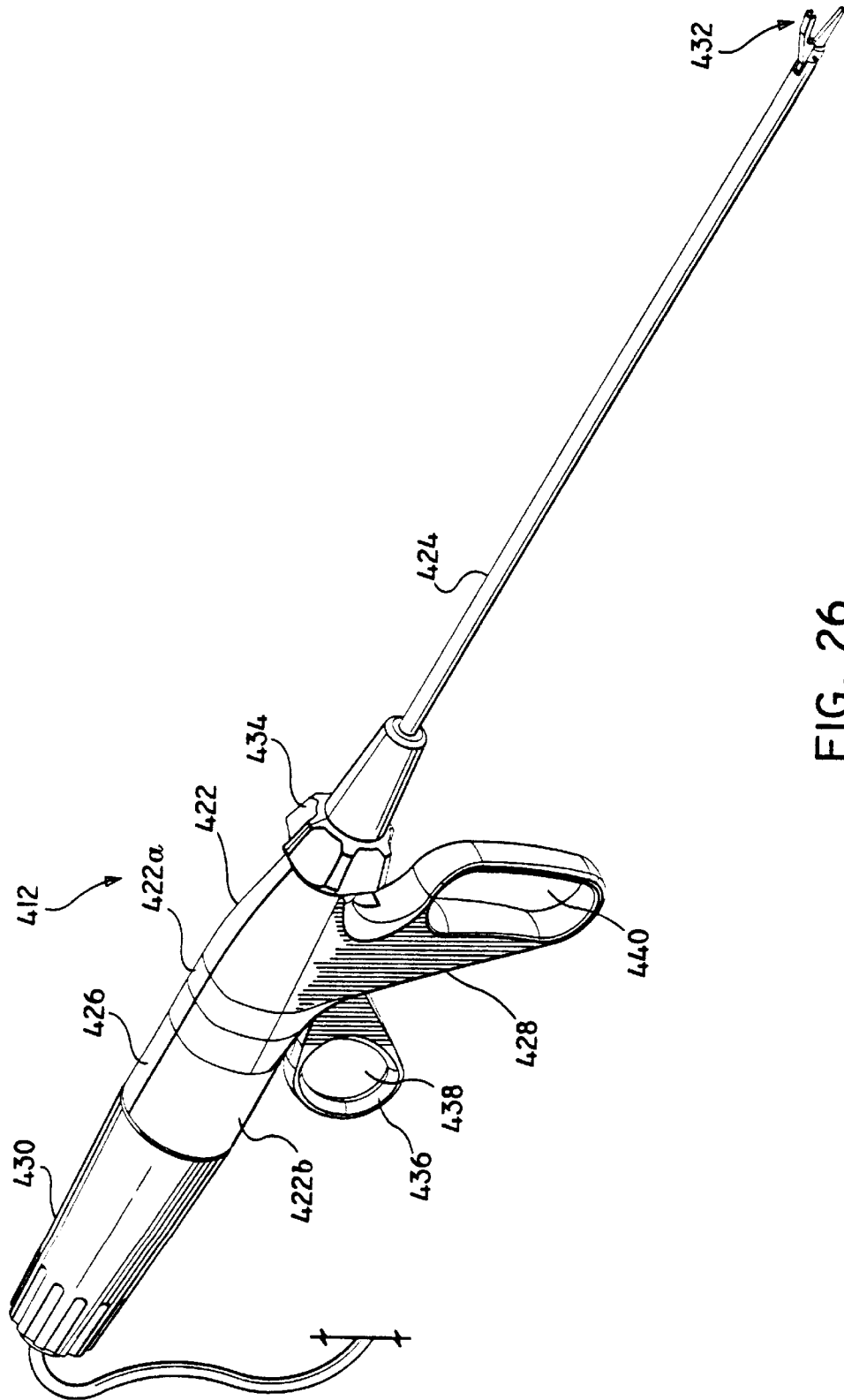

FIG. 26

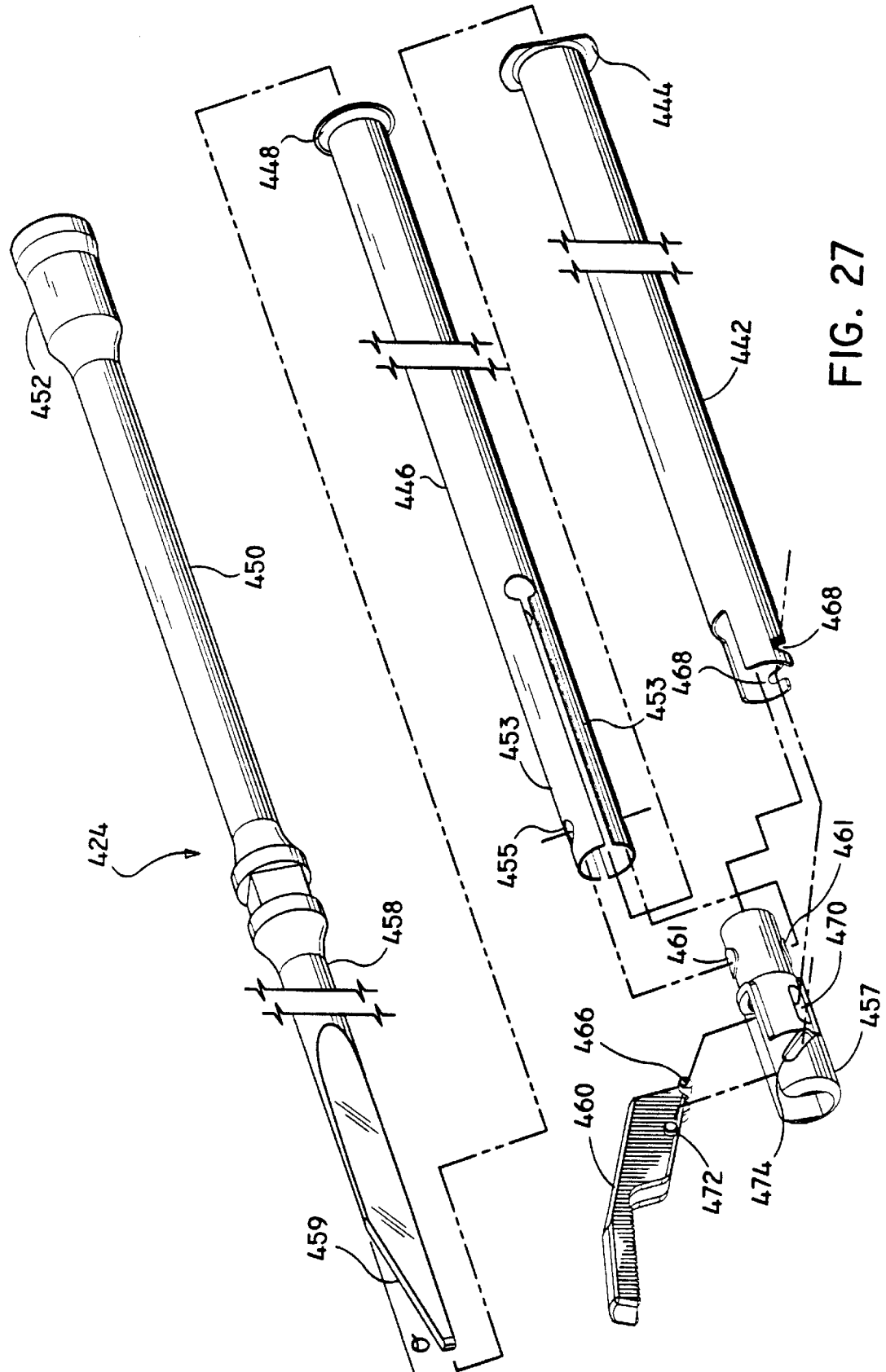
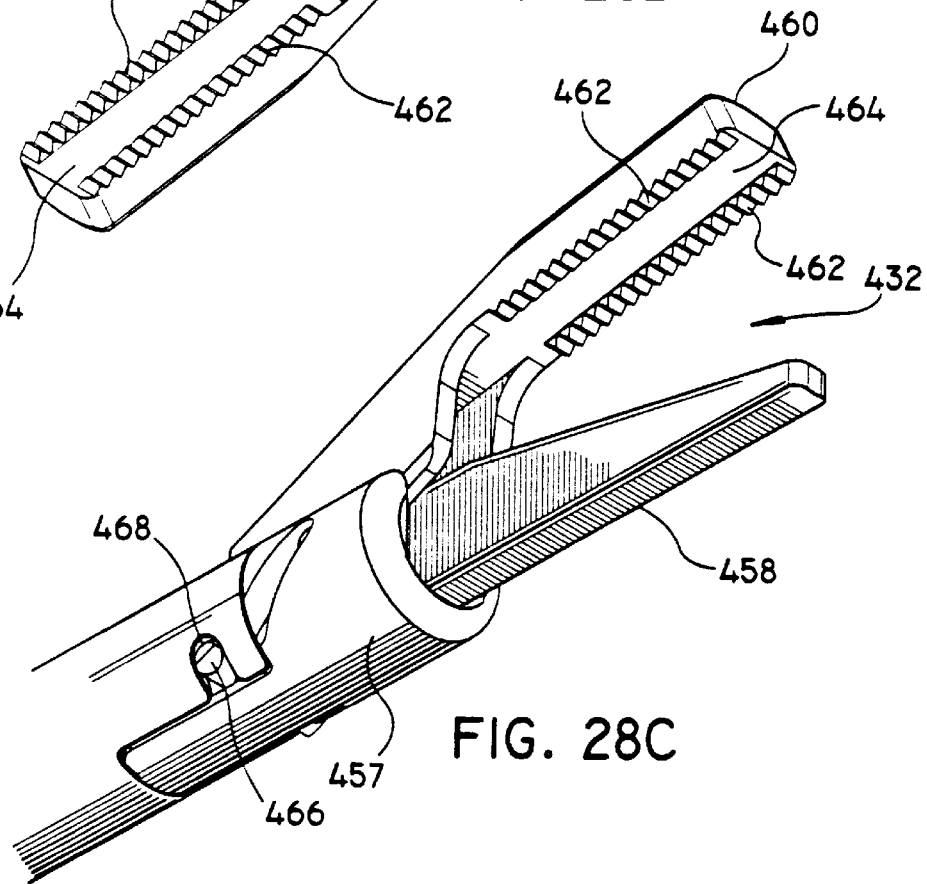
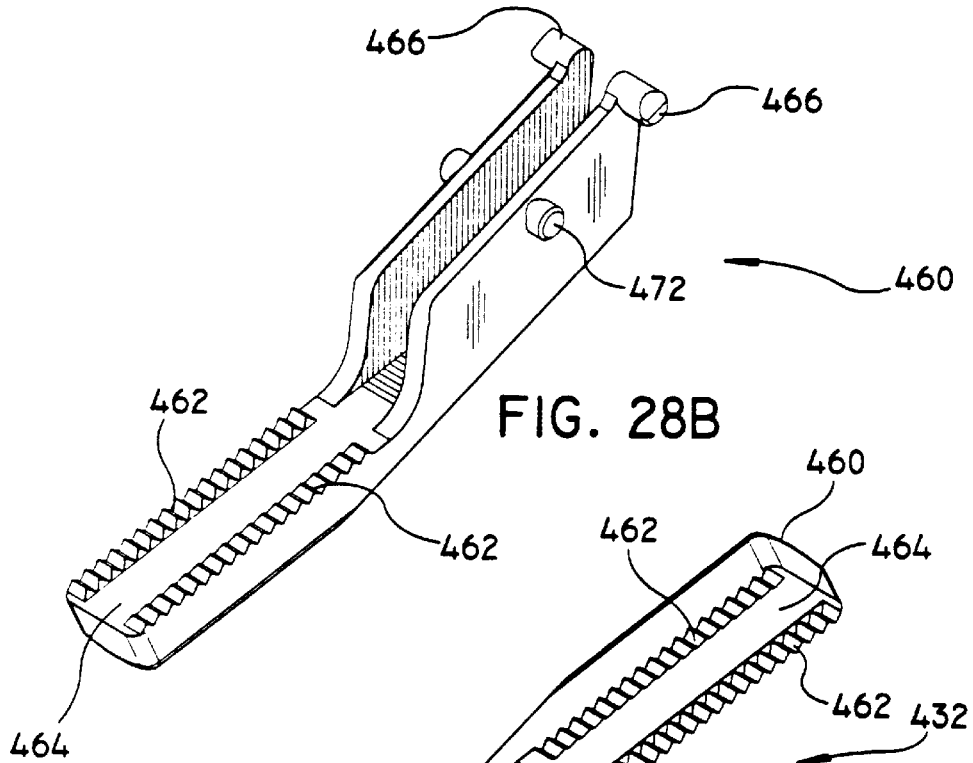
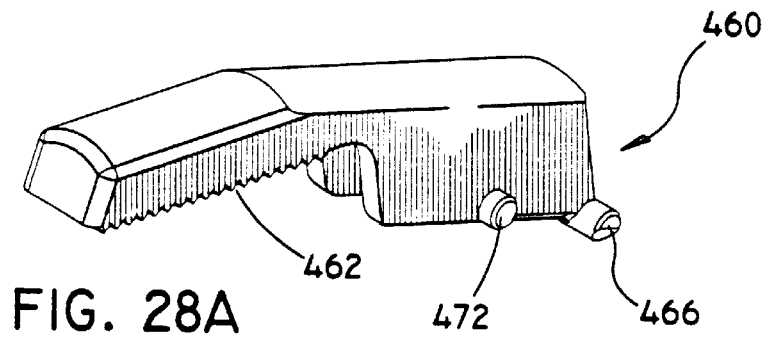

FIG. 27



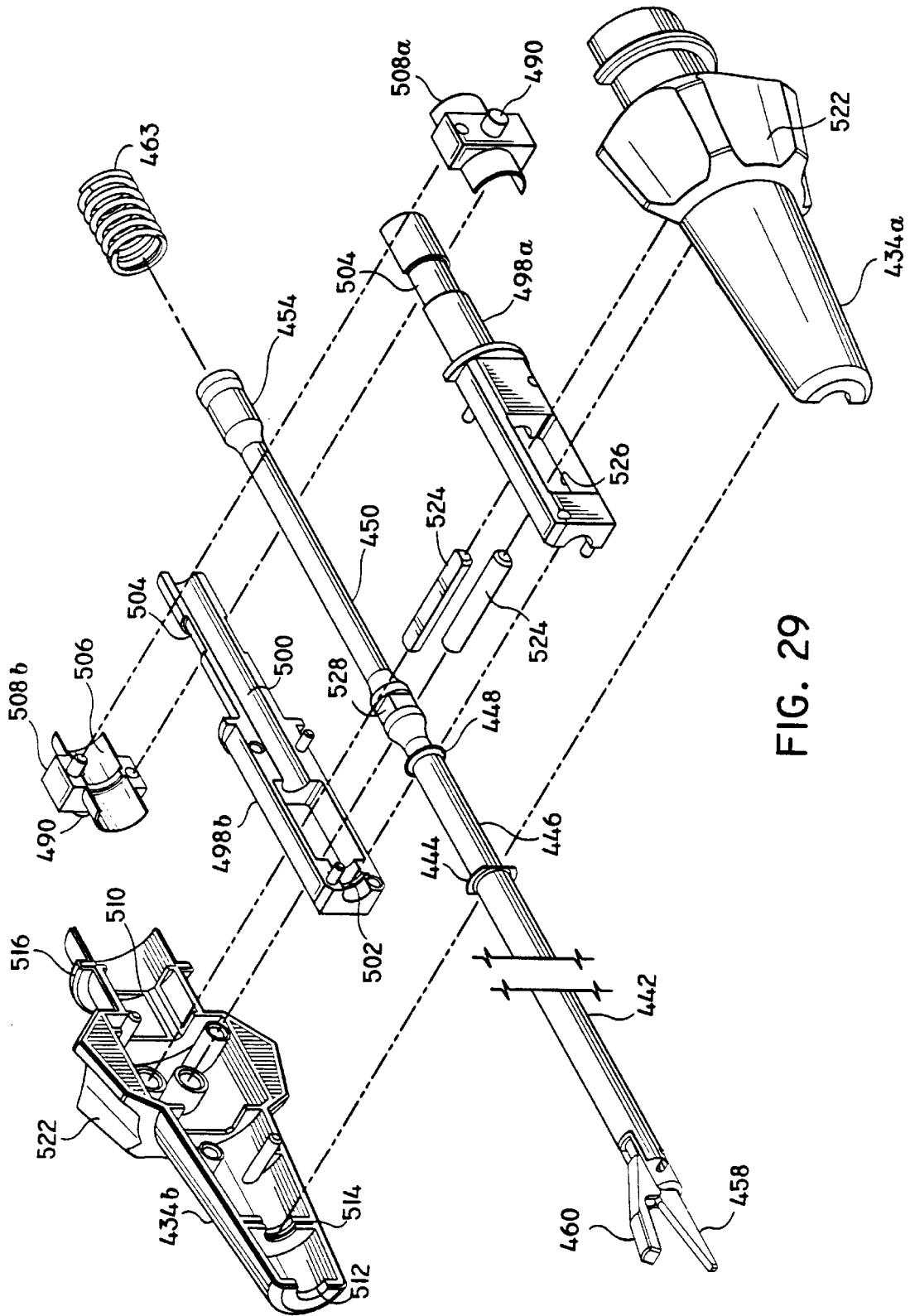

FIG. 29

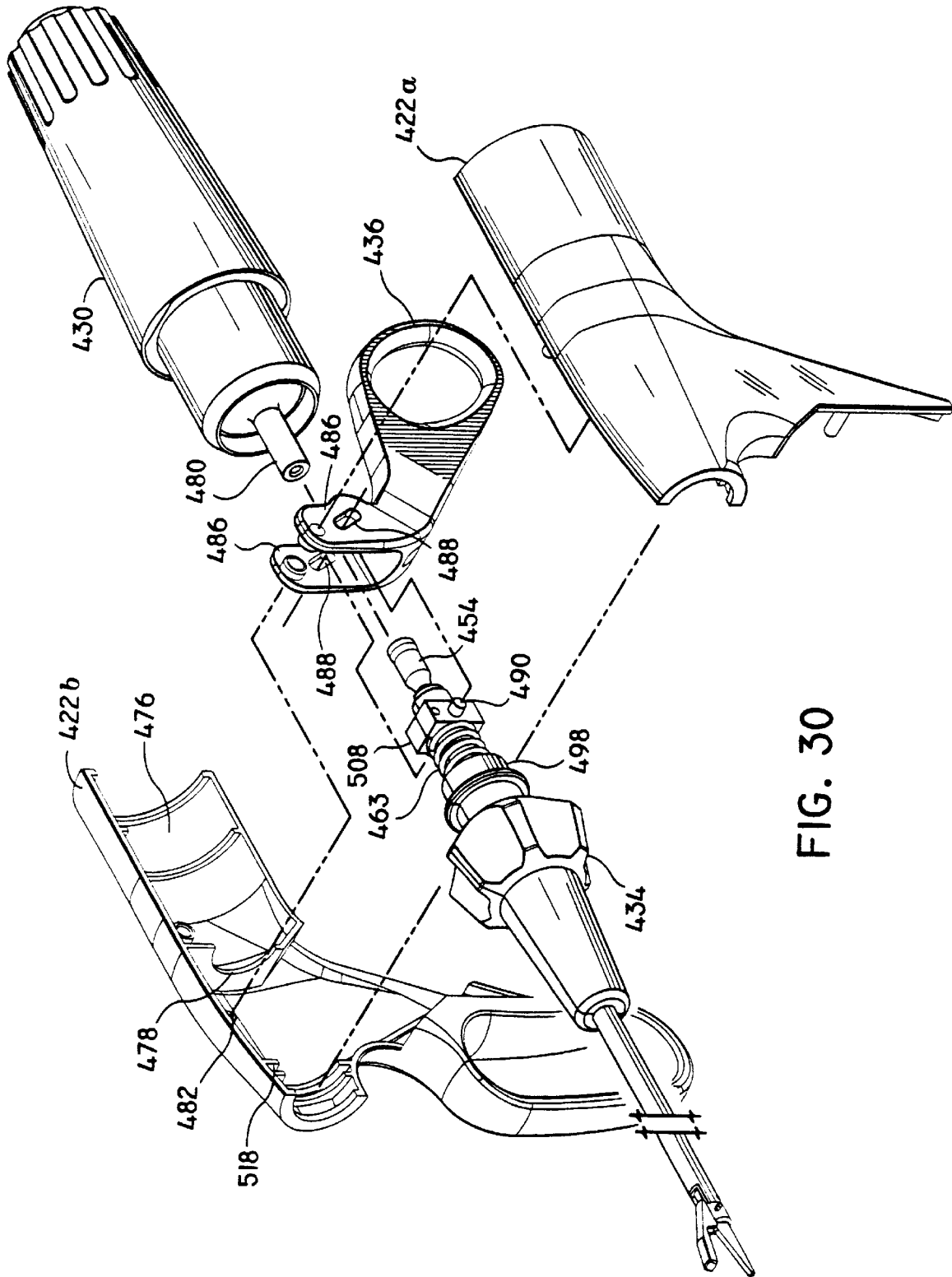

FIG. 30

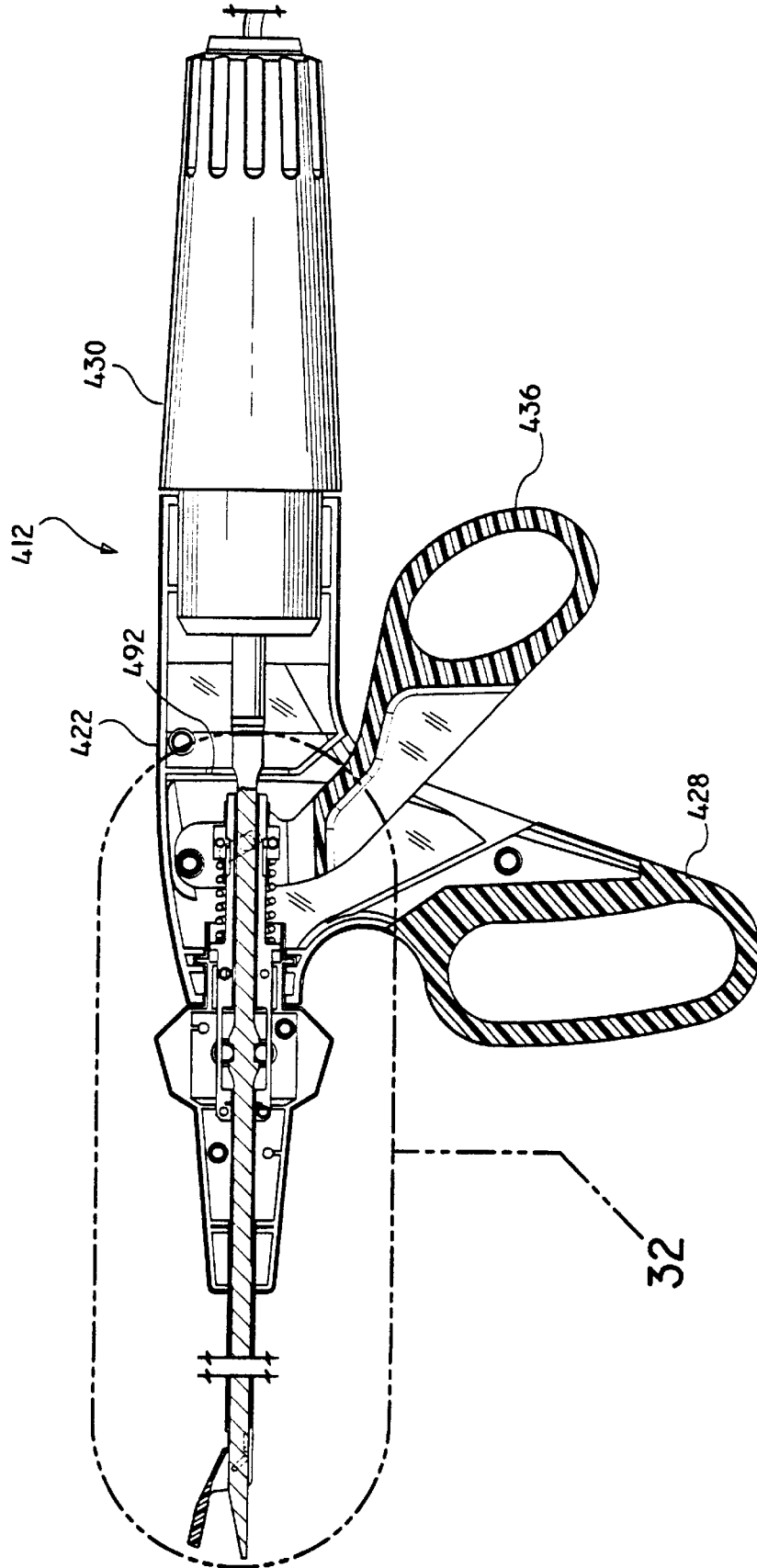

FIG. 31

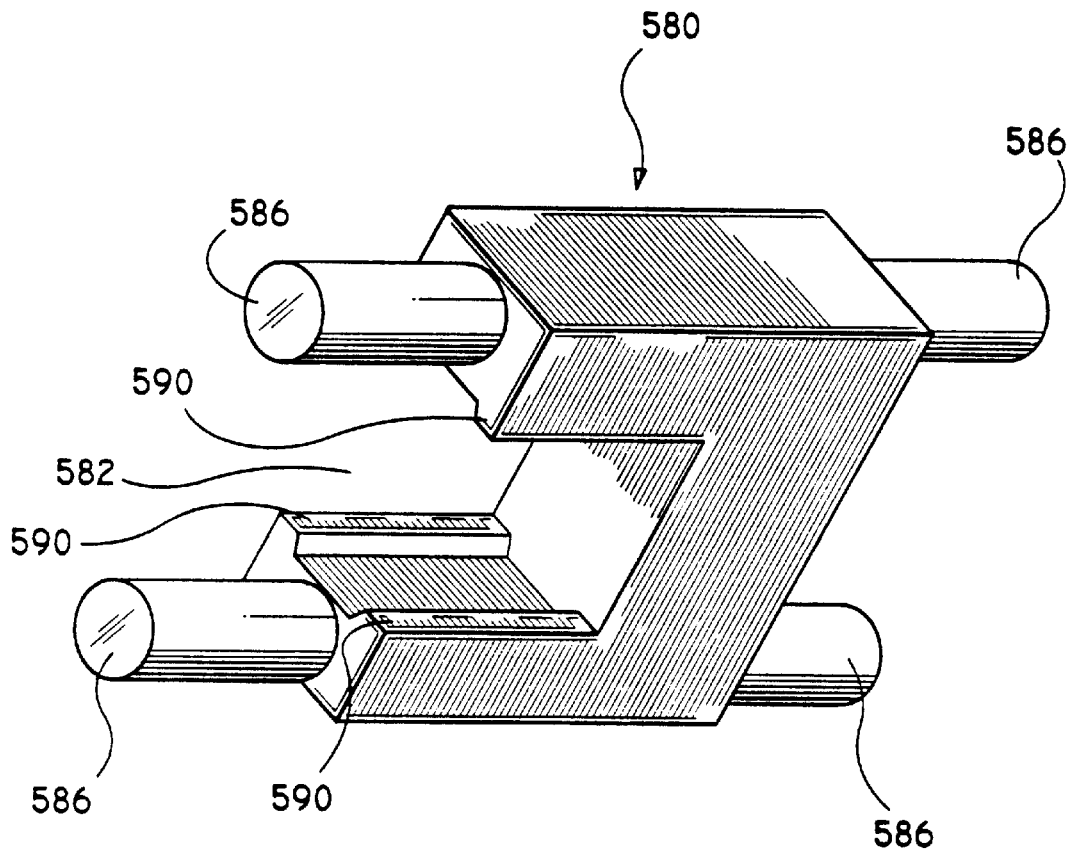

FIG. 31A

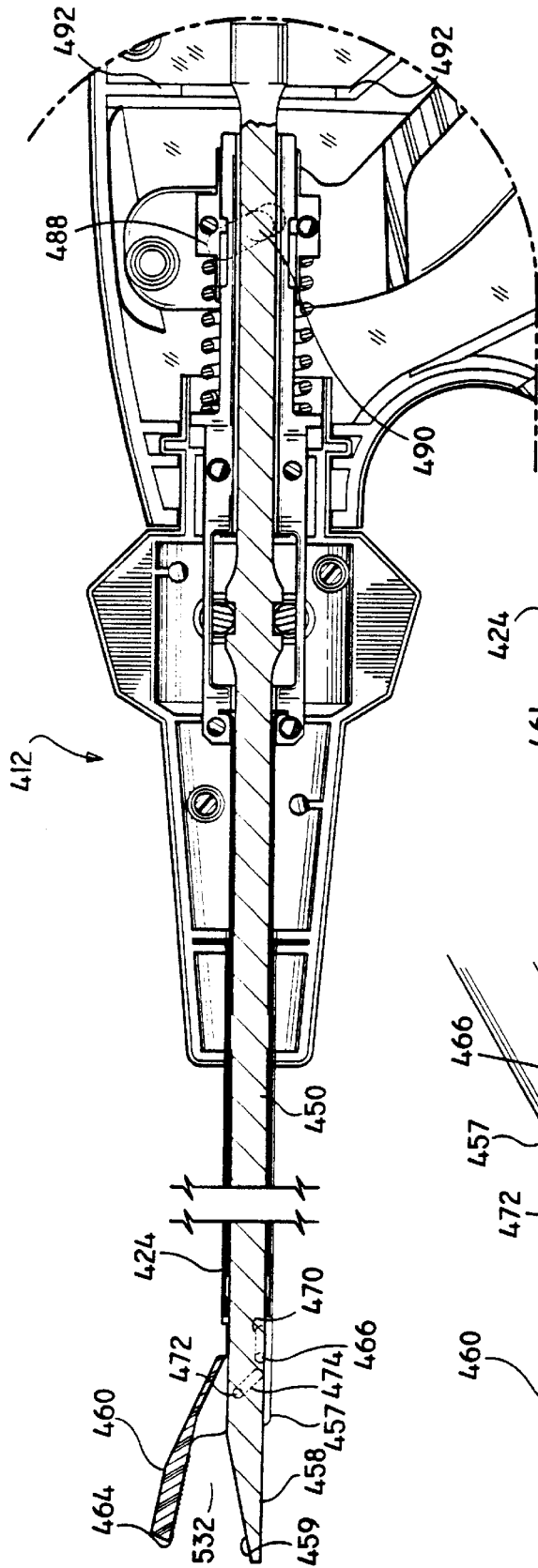

FIG. 32

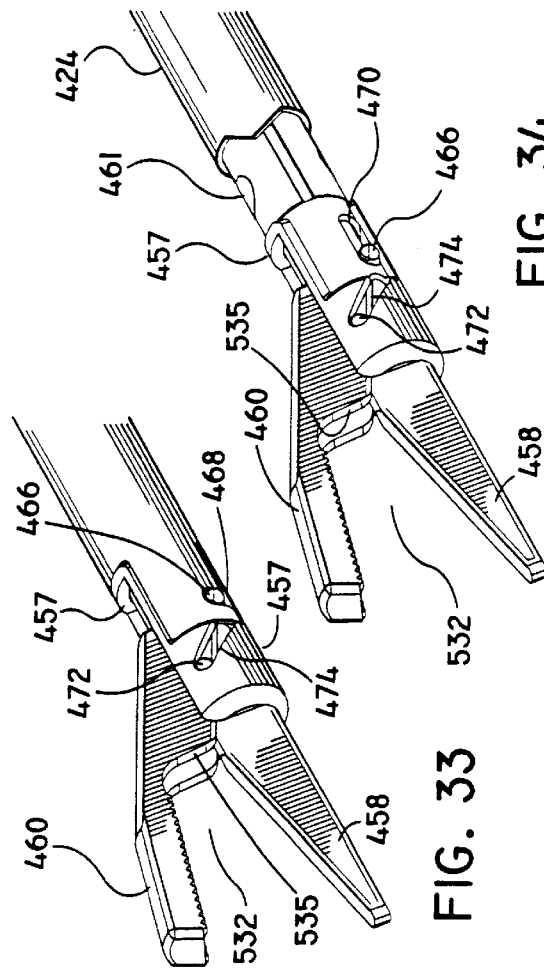

FIG. 33

FIG. 34

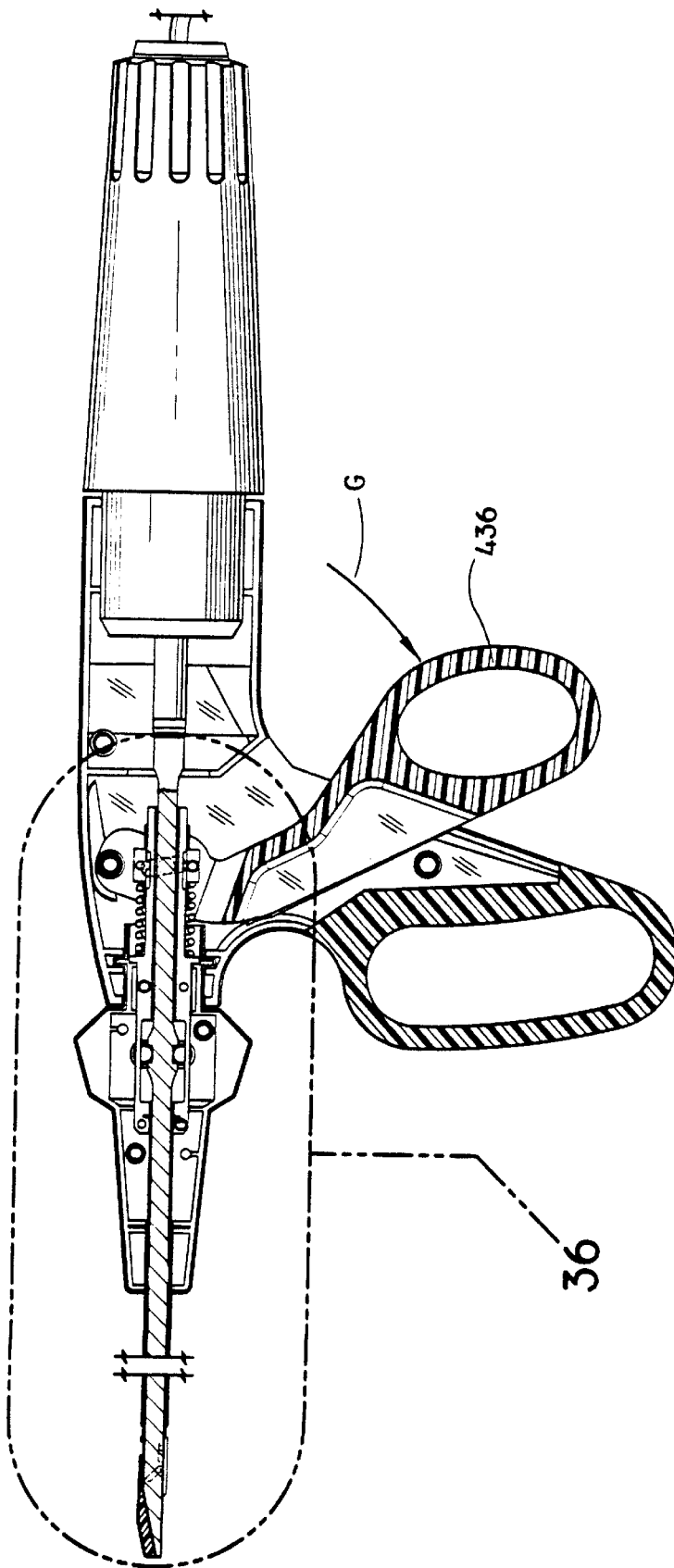

FIG. 35

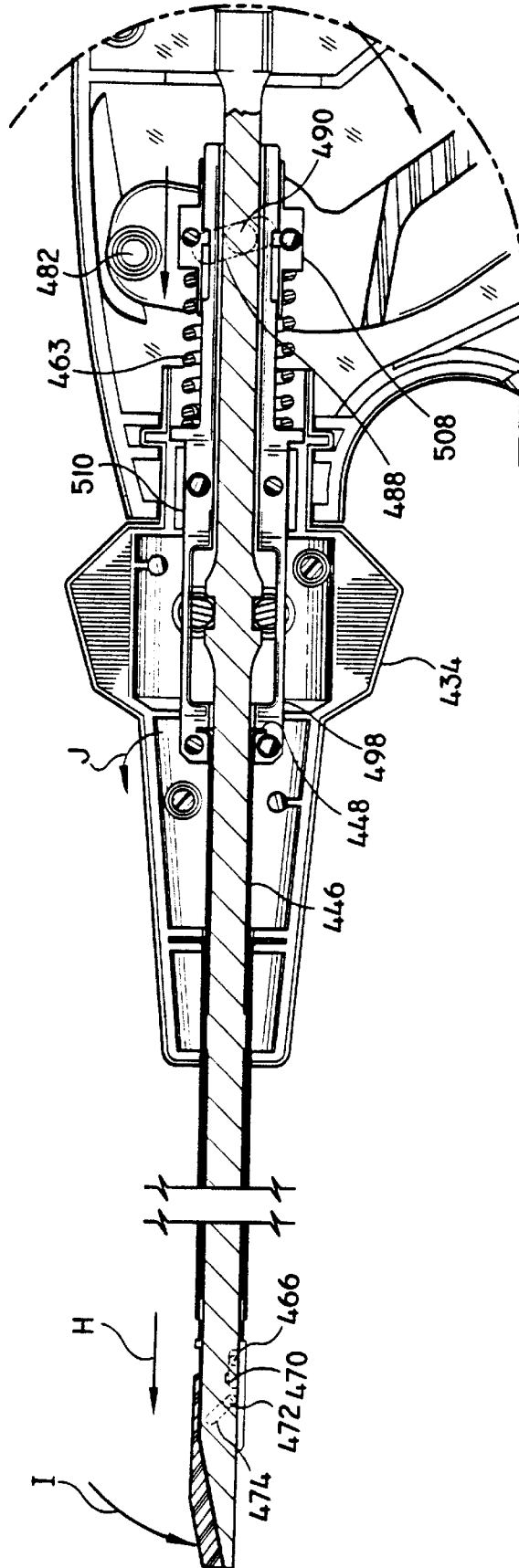

FIG. 36

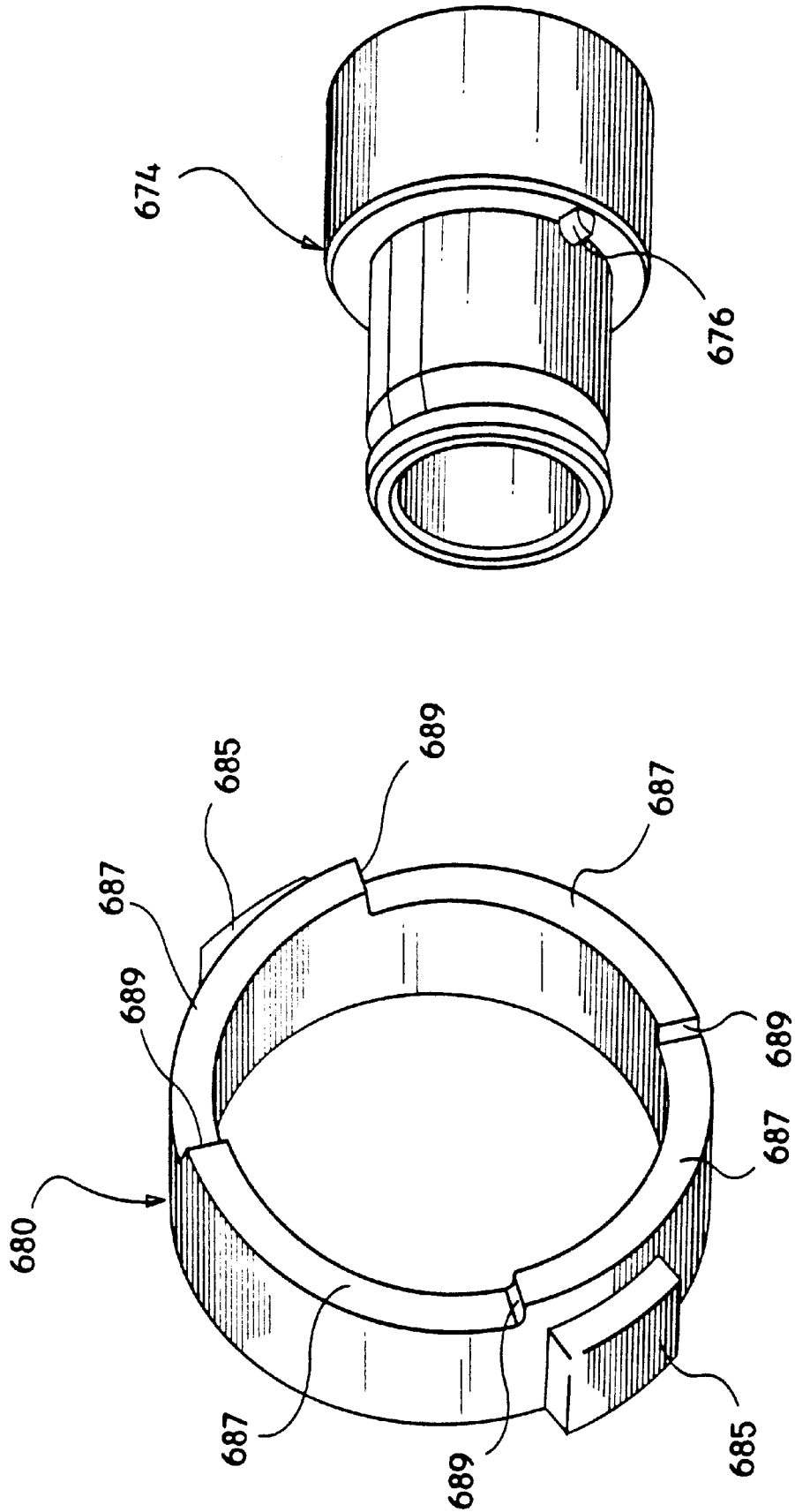

FIG. 38D

FIG. 38C

ULTRASONIC DISSECTION AND COAGULATION SYSTEM

CROSS-REFERENCE TO RELATED APPLICATIONS

This application is a continuation of copending application Ser. No. 08/911,207 pending filed Aug. 14, 1997 the contents of which are incorporated herein by reference.

BACKGROUND

1. Technical Field

The present disclosure relates to an ultrasonic dissection and coagulation system for surgical use. More specifically, the present disclosure relates to an ultrasonic instrument including an angled blade and a clamp member particularly suited for performing dissection and coagulation of tissue.

2. Background of Related Art

Ultrasonic instruments for surgical use and the benefits associated therewith are well known. For example, the use of an ultrasonic generator in conjunction with a surgical scalpel facilitates faster and easier cutting of organic tissue and accelerates blood vessel clotting in the area of the cut, i.e., accelerated coagulation. Improved cutting results from increased body tissue to scalpel contact caused by the high frequency of vibration of the scalpel blade with respect to body tissue. Improved coagulation results from heat generated by contact between the scalpel blade and the body tissue as the scalpel blade is vibrated at a high frequency. Thus, in order to reap the advantages associated with ultrasonic energy, good blade to tissue contact is important.

U.S. Pat. No. 3,862,630 ("Balamuth") discloses an ultrasonic system including an ultrasonic motor, a tool member having a working surface oriented normal to the direction of mechanical vibration generated by the ultrasonic motor, and a clamp member extending parallel to the tool member for compressing tissue against the tool member. U.S. Pat. No. 5,322,055 ("Davison") discloses an ultrasonic surgical instrument adapted for endoscopic use having a blade and a clamp movable in relation to the blade to capture tissue therebetween. The blade and the clamp define a clamping region having a plane which is parallel to the longitudinal axis of the surgical instrument. During an endoscopic procedure, movement of the instrument is limited to movement along an axis parallel to the plane of the clamping region. Thus, no additional blade force is imposed on the body tissue as a result of movement of the instrument.

Accordingly, a need exists for an improved ultrasonic surgical instrument which is easy to use and provides fast and easy cutting and improved coagulation.

SUMMARY

In accordance with the present disclosure, an ultrasonic tissue dissector is provided for dissection and coagulation of tissue. The surgical instrument includes a housing and a vibration coupler supported within the housing operably connected to an ultrasonic generator. An angled blade member is connected to the distal end of the vibration coupler to conduct high frequency vibration to the blade member. The blade member has a cutting surface that forms an obtuse angle with respect to an axis transverse to the longitudinal axis of the vibration coupler. The blade member may also have a width that tapers in the distal direction. A clamp member may be positioned adjacent to the blade member and is movable from an open position to a clamped position to capture tissue therebetween. The clamp member and

angled blade member combine to enhance contact between the tissue and the blade member during operation of the instrument to improve the performance of the instrument.

In an alternate embodiment, the surgical instrument is operatively associated with a control module and a remote actuator and has a housing and an elongated body portion extending from the housing. An ultrasonic transducer supported within the housing is operatively connected to a cutting blade by a vibration coupler. The vibration coupler conducts high frequency vibration from the ultrasonic transducer to the cutting blade. The cutting blade has a cutting surface which is angled with respect to the longitudinal axis of the elongated body portion and, thus, with respect to the axis of vibration. A clamp member having a tissue contact surface is positioned adjacent to the blade member and is movable via an actuator tube from an open position in which the tissue contact surface is spaced from the cutting surface to a clamped position in which the tissue contact surface is in close juxtaposed alignment with the cutting surface to clamp tissue therebetween. Because the cutting blade is angled with respect to the longitudinal axis of the elongated body portion, the contact pressure applied by the blade surface is increased as the force applied to the instrument is increased.

BRIEF DESCRIPTION OF THE DRAWINGS

Various preferred embodiments are described herein with reference to the drawings, wherein:

FIG. 1 is a perspective view of one embodiment of the ultrasonic tissue dissector in the open position;

FIG. 2 is a side cross-sectional view taken along section line 2—2 of FIG. 1;

FIG. 3 is a side cross-sectional view taken along section line 3—3 of FIG. 1;

FIG. 3A is a front cross-sectional view taken along section line 3A—3A of FIG. 3;

FIG. 3B is a cross-sectional view of the blade member and clamp of an alternate embodiment of the ultrasonic tissue dissector;

FIG. 4 is a side cross-sectional view of the proximal end of the ultrasonic tissue dissector of FIG. 1;

FIG. 5 is a side cross-sectional view of the distal end of the ultrasonic tissue dissector of FIG. 1 shown in the clamped position;

FIG. 5A is a cross-sectional view taken along section line 5A—5A of FIG. 5;

FIG. 6 is a side cross-sectional view of the proximal end of an alternate embodiment of the ultrasonic tissue dissector shown in the open position;

FIG. 7 is a partial side cross-sectional view of the distal end of the ultrasonic tissue dissector of FIG. 6 shown in the open position;

FIG. 7A is a cross-sectional view taken along section line 7A—7A of FIG. 7;

FIG. 7B is a cross-sectional view of the blade member and clamp of an alternate embodiment of the ultrasonic tissue dissector;

FIG. 7C is a cross-sectional view of the distal end of another alternate embodiment of the ultrasonic tissue dissector;

FIG. 8 is a side cross-sectional view of the proximal end of the ultrasonic tissue dissector of FIG. 6 shown in the clamped position;

FIG. 9 is a cross-sectional view of the distal end of the ultrasonic tissue dissector of FIG. 6 shown in the clamped position;

FIG. 9A is a cross-sectional view taken along section line 9A—9A of FIG. 9;

FIG. 10 is a partial cross-sectional view showing the ultrasonic tissue dissector positioned in a trocar cannula.

FIG. 11 is a perspective view of an alternate embodiment of the ultrasonic dissection and coagulation system with the ultrasonic instrument inserted partially through a cannula assembly;

FIG. 12 is a perspective view of the ultrasonic instrument of FIG. 11;

FIG. 13 is a perspective view with parts separated of the clamp of FIG. 11;

FIG. 14 is a perspective view with parts separated of the elongated body portion of the ultrasonic instrument of FIG. 11;

FIG. 15 is a perspective view with parts separated of the handle assembly of the ultrasonic instrument of FIG. 11;

FIG. 16 is a perspective view with parts separated of the rotation assembly of the ultrasonic instrument of FIG. 11;

FIG. 17 is a side partial cutaway view of the ultrasonic instrument of FIG. 11 in the open position;

FIG. 18 is an enlarged view of the indicated area of detail of FIG. 17 illustrating the clamp in the open position;

FIG. 19 is a perspective view of the distal end of the elongated body portion of the ultrasonic instrument of FIG. 11 with the clamp in the open position;

FIG. 20 is a perspective partial cutaway view of the distal end of the elongated body portion of the ultrasonic instrument of FIG. 11 with the clamp in the open position;

FIG. 21 is a front elevational view taken along line 21—21 of FIG. 18;

FIG. 22 is a side partial cutaway view of the ultrasonic instrument of FIG. 11 with the clamp in the clamped (closed) position;

FIG. 23 is an enlarged view of the indicated area of detail of FIG. 22 illustrating the clamp in the closed position;

FIG. 24 is a side cross-sectional view of the distal end of the elongated body portion of the ultrasonic instrument of FIG. 11 in the clamped position;

FIG. 25 is a perspective view of the ultrasonic instrument of FIG. 11 with the elongated body portion partially rotated;

FIG. 26 is a side perspective view of another alternate embodiment of the ultrasonic instrument in the open position;

FIG. 27 is a perspective view of the elongated body portion of the ultrasonic instrument shown in FIG. 26;

FIG. 28A is a side perspective view of the clamp of the ultrasonic instrument shown in FIG. 26;

FIG. 28B is a side perspective view of the tissue contact surface of the clamp shown in FIG. 28A;

FIG. 28C is a side perspective view of the distal end of the elongated body portion of the ultrasonic instrument shown in FIG. 26;

FIG. 29 is a side perspective view of the elongated body portion and rotation assembly of the ultrasonic instrument shown in FIG. 26;

FIG. 30 is a side perspective view of the handle assembly and transducer assembly of the ultrasonic instrument shown in FIG. 26;

FIG. 31 is a side partial cross-sectional view of the ultrasonic instrument shown in FIG. 26 in the open position;

FIG. 31A is an enlarged perspective view of a C-clip locator for the vibration coupler;

FIG. 32 is an enlarged view of the indicated area of detail of FIG. 31 illustrating the clamp in the open position;

FIG. 33 is a side perspective view of the distal end of the elongated body portion of the ultrasonic instrument shown in FIG. 33;

FIG. 34 is a side perspective, partial cutaway view of the distal end of the elongated body portion of the ultrasonic instrument shown in FIG. 33;

FIG. 35 is a side partial cross-sectional view of the ultrasonic instrument of FIG. 26 in the closed position;

FIG. 36 is an enlarged view of the indicated area of detail of FIG. 35 illustrating the clamp in the closed position;

FIG. 37 is a side cross-sectional view of an alternate embodiment of the ultrasonic transducer of FIG. 11;

FIG. 38A is a side view of a torque wrench assembly in engagement with the ultrasonic transducer of FIG. 37A;

FIG. 38B is a side cross-sectional view taken along section line 38B—38B of FIG. 37;

FIG. 38C is a perspective view of the cam member of the torque wrench assembly shown in FIG. 38B; and

FIG. 38D is a perspective view of the driver member of the torque wrench assembly shown in FIG. 38B.

DETAILED DESCRIPTION OF THE PREFERRED EMBODIMENTS

Preferred embodiments of the presently disclosed ultrasonic dissection and coagulation system will now be described in detail with reference to the drawings, in which like reference numerals designate identical or corresponding elements in each of the several views.

FIGS. 1–5 illustrate one embodiment of the presently disclosed ultrasonic tissue dissector shown generally as 10 in FIG. 1. Briefly, ultrasonic tissue dissector 10 includes a handle assembly 12 including a movable handle member 14 and a stationary gripping member 16. A housing portion 18 is integrally formed with the stationary gripping member 16. Preferably, housing portion 18 and stationary gripping member 16 are monolithically constructed from two molded sections. A generally cylindrical elongated body portion 20 extends from the handle assembly 12 and is provided with an open distal end 22.

Referring to FIGS. 2–3, a transducer 24 is supported within housing portion 18 on support members 23 and is adapted to be connected to an ultrasonic generator 25 (shown schematically) via a power cable 26. A vibration coupler or horn 28 is positioned in engagement with transducer 24 and extends through elongated body portion 20. The vibration coupler 28 includes a tapered section 28a which is fixedly connected at its distal end to a blade member 30 having a cutting surface 32. The blade member 30 extends from open distal end 22 of elongated body portion 20. Alternately, the blade member 30 and the vibration coupler 28 may be integrally constructed. Blade member 30 has a straight cutting surface 32 angled away from the longitudinal axis of the coupler 28 (and elongated body portion 20) such that cutting surface 32 forms an obtuse angle with the transverse axis Y of the elongated body portion 20. Transverse axis Y is also parallel to the transverse axis R of the vibration coupler 28. As shown in the illustrated embodiment, the cutting surface 32 is angled downwardly and outwardly away from the central longitudinal axis of elongated body portion 20 and away from the clamp and actuation rod 34. Cutting surface 32 further defines a fixed acute angle Θ with respect to the longitudinal axis of the elongated body portion 20, which preferably

ranges from about 15 degrees to about 70 degrees. A base portion **33** of blade **30** adjacent cutting surface **32** has a radius of curvature defining a smooth surface to prevent inadvertent damage to tissue or organs at a surgical site. The base portion **33** should not extend below the outer surface of elongated body portion **20** to facilitate passage through a cannula during an endoscopic procedure. Preferably, the base portion **33** extends outwardly to a position aligned with the outermost diameter of the vibration coupler **28**.

FIG. 3A illustrates a cross-sectional view of the blade showing the blade having a generally planar cutting surface **32**. FIG. 3B illustrates an alternate embodiment of the blade in which blade **30a** has a top section having a triangular cross-section. Top walls **30b** of blade **30a** converge toward a linear edge which defines the cutting surface **32a**. Alternately, a series of linear edges may be provided to define the cutting surface.

Referring to FIGS. 2 and 3, ultrasonic generator **25** supplies electrical energy having ultrasonic frequency to the transducer **24** to cause oscillation of the transducer **24** in a known manner. The transducer **24**, which may be one of a variety of electromechanical types, e.g., electrodynamic, piezoelectric, magnetostrictive, is connected in end-to-end relation with the vibration coupler **28** to cause oscillation of the vibration coupler and corresponding oscillation of angled blade member **30**.

An actuation rod **34** has a proximal end movably supported within housing portion **18**. The actuation rod **34** extends through elongated body portion **20** and includes a distal end positioned adjacent the distal end of elongated body portion **20**. Preferably, actuation rod **34** and vibration coupler **28** are supported within body portion **20** by support spacers **36**, although any conventional support structure which allows for linear movement of the actuation rod may be used. Support spacers **36** are positioned at each end of vibration coupler **28** and actuation rod **34** adjacent a node on the vibration coupler **28**. Additional spacers **36** can also be provided and positioned adjacent other nodes on the vibration coupler **28**. A clamp **38** having a clamping surface **40** is connected to the distal end of the actuation rod **34** by a pivot pin **42**. The clamp **38** also is pivotably connected to the distal end of elongated body portion **20** by a pivot pin **44** and is positioned adjacent to the blade **30** such that upon linear advancement of actuation rod **34**, clamp surface **40** is moved into juxtaposed alignment with cutting surface **32**. Due to the angle of the clamp surface **40** and cutting surface **32**, tissue is pulled proximally towards the cutting surface **32** when clamped.

The proximal end of the actuation rod **34** is frictionally received in a slidable coupling **46** positioned within the housing portion **18**. Coupling **46** is restricted to linear movement by walls **48** of housing portion **18**. Movable handle **14** is operably connected to coupling **46** by link **50** which is pivotably connected at one end to coupling **46** by pin **52** and pivotably connected at its opposite end to movable handle **14** by pin **54**. Movable handle **14** is pivotably connected to housing portion **18** by pivot pin **56**. A biasing member **58** is positioned within the housing to bias movable handle **14** distally (counterclockwise) to thereby maintain coupling **46** proximally within housing portion **18** and maintain actuation rod **34** in a retracted position. When actuation rod **34** is in the retracted position, clamp **38** is in an open position (see FIG. 3). Alternately, the clamp **38** can be biased to a clamping (closed) position.

In use, ultrasonic tissue dissector **10** is grasped about the handle assembly **12** and moved to position the cutting

surface **32** adjacent tissue **62** to be dissected and/or coagulated (See FIG. 3A). Because the movable handle **14** in the illustrated embodiment is biased by biasing member **58** to the open position, ultrasonic tissue dissector **10** can be positioned without operation of movable handle **14**.

Referring now to FIGS. 4 and 5, after ultrasonic tissue dissector **10** is properly positioned about body tissue **62**, movable handle **14** is pivoted in a clockwise direction, as indicated by arrow "A" in FIG. 4, to advance slidable coupling **46** distally, via link **50**. Movement of coupling **46** advances actuation rod **34** distally, as indicated by arrow "B" in FIG. 5, to pivot clamp **38** clockwise about pivot pin **44** and clamp tissue **62** between cutting surface **32** and clamping surface **40**. See FIG. 5A. The ultrasonic generator may now be energized to cause linear oscillation of blade **30** with respect to clamp **38** to effect dissection and/or coagulation of tissue **62**.

FIGS. 6-9 illustrate an alternate embodiment of the presently disclosed ultrasonic tissue dissector shown generally in FIG. 6 as **100**. Referring to FIGS. 6 and 7, ultrasonic tissue dissector **100** includes a handle assembly **112** including a movable handle **114** and stationary gripping member **116**. A housing portion **118** is integrally formed with the stationary gripping member **116**. Preferably, housing portion **118** and stationary gripping member **116** are monolithically constructed from two molded sections. A generally cylindrical elongated body portion **120** extends from the handle assembly **112** and is provided with an open distal end **122**.

As illustrated in FIGS. 6 and 7, a transducer **124** is supported within housing **118** on support members **123** and is adapted to be connected to an ultrasonic generator (not shown) via a power cable **126**. Vibration coupler **128** is positioned in engagement with transducer **124** and extends through elongated body portion **120**. The vibration coupler **128** includes a tapered section **128a** which is fixedly connected at its distal end to a blade member **130** having a cutting surface **132**. Blade member **130** extends from open distal end **122** of elongated body portion **120**. Alternately, blade member **130** and vibration coupler **128** may be integrally constructed. Blade member **130** has a generally straight cutting surface **132** which is angled away from the longitudinal axis of the coupler **128** and elongated body portion **120** such that cutting surface **132** forms an obtuse angle with respect to a transverse axis Y of the elongated body portion **120**. Transverse axis Y is also parallel to the transverse axis R of the vibration coupler **28**. As shown in the illustrated embodiment, the cutting surface **132** is angled downwardly and outwardly away from the central longitudinal axis of elongated body portion **120** and away from the clamp and clamp actuation rod **134**. Cutting surface **132** defines a fixed acute angle Θ , with respect to the longitudinal axis of elongated body portion **120** preferably, from about 15 degrees to about 70 degrees. A base portion **133** of blade **130** adjacent cutting surface **132** has a radius of curvature defining a smooth surface which prevents inadvertent damage to tissue or organs at a surgical site. Base portion **133** should not extend below the outer surface of elongated body portion **120** to facilitate passage through a cannula during an endoscopic procedure. Preferably, base portion **133** extends outwardly a distance aligned with the outermost diameter of the vibration coupler **128**.

FIG. 7A illustrates a cross-sectional view of the blade showing the blade having a generally planar cutting surface **132**. FIG. 7B illustrates an alternate embodiment of the blade in which the blade **130a** has a top section having a triangular cross-section. Top walls **130b** of the blade **130a** converge toward a linear edge which defines the cutting

surface **132a**. Alternately, a series of linear edges may be provided to define the cutting surface.

FIG. 7C illustrates a side cross-sectional view of another alternate embodiment of the blade. Blade **130b** has a first surface **131b** parallel to the longitudinal axis of the vibration coupler **128b** (and body portion **120b**). A straight cutting surface **132b** is angled away from the longitudinal axis of the coupler **128b** (and elongated body portion **120b**) such that cutting surface **132b** forms an obtuse angle with the transverse axis Y of the elongated body portion **120**. Blade **130b** tapers in thickness toward its distal end. Although shown in conjunction with linearly movable clamp **138b**, blade **130b**, alternately, may be used in conjunction with a pivotable clamp.

Referring again to FIGS. 6 and 7, an actuation rod **134** has a proximal end movably supported within housing portion **118**. The actuation rod **134** extends through elongated body portion **120** and includes a distal end positioned adjacent the distal end of elongated body portion **120**. Preferably, actuation rod **134** and vibration coupler **128** are supported within body portion **120** by support spacers **136**, although any conventional support structure which allows for linear movement of the actuation rod may be used. Support spacers **136** are positioned at each end of the vibration coupler **128** and actuation rod **134** adjacent a node on the vibration coupler **128**. Additional spacers can also be provided and positioned adjacent other nodes. A clamp **138** is connected to the distal end of the actuation rod **134** and includes clamp surface **140** which is parallel to and faces cutting edge **132** of blade member **130**. The clamp **138** is movable with respect to the blade member **130** from an open position to a clamped position to capture tissue between the cutting edge **132** and the clamp surface **140**. In the clamped position, cutting edge **132** and clamp surface **140** are in juxtaposed alignment. Alternately, clamp **138** may be formed integrally with the actuation rod **134** and may have a smooth texture, although a knurled or ribbed surface may be provided to facilitate grasping of tissue or to enhance coagulation. Due to the angle of the clamp surface **140** and cutting surface **132**, tissue is pulled proximally towards the cutting surface **132** when clamped.

The proximal end of the actuation rod **134** is frictionally received in a slidably coupling **146** positioned within the housing portion **118**. The coupling **146** is restricted to linear movement by walls **148** of housing portion **118**. Movable handle **114** is operably connected to slidably coupling **146** by a link **150** which is pivotably connected at one end to the coupling **146** by pin **152** and pivotably connected at its opposite end to movable handle **114** by pin **154**. Movable handle **114** is pivotably connected to housing portion **118** by pivot pin **156**. A biasing member **158** is positioned within housing portion **118** to bias the movable handle **114** distally to thereby maintain coupling **146** distally within housing portion **118** and maintain actuation rod **134** in a distal position. When actuation rod **134** is in its distal position, clamping surface **140** is spaced from cutting surface **132** to define the open position of the ultrasonic tissue dissector **100**. Alternately, the clamp member can be biased to an open position.

In use, ultrasonic tissue dissector **100** is grasped about the handle assembly **112** and moved to position the cutting surface **132** adjacent body tissue **162** to be dissected and/or coagulated (See FIGS. 7 and 7A). Because the movable handle in the illustrated embodiment is biased by biasing member **158** to the open position, the clamp is in the distal position and ultrasonic tissue dissector **100** can be positioned about tissue without operation of movable handle **14**.

Referring now to FIGS. 8 and 9, after ultrasonic tissue dissector **100** is properly positioned about body tissue **162**, movable handle **114** is pivoted in a clockwise direction, as indicated by arrow "C" in FIG. 8 to move slidably coupling **146**, via link **150**, proximally within housing portion **118**. Movement of coupling **146** moves actuation rod **134** proximally as indicated by arrow "D" in FIG. 9 to move clamping surface **140** into alignment with cutting surface **132** to clamp tissue **162** therebetween. The ultrasonic generator may now be energized to cause linear oscillation of blade **130** with respect to clamp **138** to effect dissection and/or coagulation of tissue **162**.

FIG. 10 illustrates endoscopic use of the ultrasonic tissue dissector. As shown, ultrasonic tissue dissector **10** (or alternately dissector **100**) is inserted through body tissue **170** via cannula **198** into cavity **172** to access tissue.

FIG. 11 illustrates another alternate embodiment of the ultrasonic instrument in conjunction with an ultrasonic dissection and coagulation system shown generally as **200**. Briefly, dissection and coagulation system **200** includes ultrasonic instrument **212**, control module **214**, and remote actuator **216**. Control module **214** is operatively connected to ultrasonic instrument **212** by electrically conductive cable **218** and functions to control the power and frequency of current supplied to ultrasonic instrument **212**. Any suitable controller capable of delivering power to ultrasonic instrument **212** can be used. Control module **214** does not form part of the invention and will not be further disclosed herein. Remote actuator **216**, e.g., pedal actuator, is operatively connected to control module **214** by electrically conductive cable **220** and can be actuated to initiate the supply of power to ultrasonic instrument **212** via control module **214** to effect vibratory motion of ultrasonic instrument **212** to cut and coagulate tissue.

As illustrated in FIG. 12, ultrasonic instrument **212** includes housing **222** and elongated body portion **224** extending distally therefrom. Housing **222** is preferably formed from molded housing half-sections **222a** and **222b** and includes a barrel portion **226** having a longitudinal axis aligned with the longitudinal axis of body portion **224** and a stationary handle portion **228** extending obliquely from barrel portion **226**. Ultrasonic transducer **230** is supported within and extends from the proximal end of housing **222** and is connected to control module **214** via cable **218**. Jaw assembly **232** is disposed adjacent the distal end of elongated body portion **224** and is actuated by moving movable handle **236** with respect to stationary handle portion **228**. Movable handle **236** and stationary handle portion **228** include openings **238** and **240**, respectively, to facilitate gripping and actuation of ultrasonic instrument **212**. Elongated body portion **224** is supported within rotatable knob **234** and may be selectively rotated by rotating knob **234** with respect to housing **222** to change the orientation of jaw assembly **232**.

FIGS. 13 and 14 illustrate elongated body portion **224** with parts separated. Elongated body portion **224** includes an outer tube **242** which is preferably cylindrical and has a proximally located annular flange **244** dimensioned to engage rotatable knob **234** (FIG. 12) as described below. An elongated actuator tube **246**, which is also preferably cylindrical, is configured to be slidably received within outer tube **242** and includes a proximally located annular flange **248** dimensioned to engage coupling member **298** (FIG. 15) which is supported within housing **222** (FIG. 12) and will be described in detail below. Vibration coupler **250** is dimensioned to extend through elongated actuator tube **246** and includes a proximal end **252** having a reduced diameter

portion **254** configured to operatively engage ultrasonic transducer **230** and a distal end **256** adapted to be operatively connected to cutting jaw **258**. A plurality of silicon rings **251** can be molded or otherwise attached to the nodal points along vibration coupler **250** to seal flow of fluids, e.g., insufflation gas, etc., from between vibration coupler **250** and actuator tube **246**. Preferably, cutting jaw **258** includes a proximal threaded extension which is dimensioned to be received within threaded distal end **256** of vibration coupler **250**. Alternately, cutting jaw **258** can be formed integrally with vibration coupler **250**, or other attachment devices can be used.

A clamp **260** having a clamp body **262** and a tissue contact member **264** removably secured to clamp body **262** is operatively connected to the distal end of actuator tube **246**. Tissue contact member **264** is preferably composed of teflon and is preferably removably fastened to clamp body **262** by a tongue and groove fastening assembly (reference numerals **261** and **265**, respectively), although other fastening assemblies are also envisioned. Tissue contact member **264** functions to isolate clamp **260** which is preferably metallic from jaw **258**, which is also preferably metallic, to prevent metal to metal contact. Tissue contact member **264** also functions to grip tissue positioned between clamp **260** and blade surface **259** of cutting jaw **258** to prevent the tissue from moving with cutting jaw **258** during vibration. Pivot members (pins) **266** located at the proximal end of clamp body **262** are configured to be received within openings **268** formed in the distal end of outer tube **242**. A guide slot **270** formed in the distal end of actuator tube **246** permits relative movement between actuator tube **246** and clamp body **262** by allowing pins **266** to move in guide slot **270**. A pair of camming members **272** are also formed on clamp body **262** and are positioned to be received within cam slots **274** formed in the distal end of actuator tube **246**. Movement of actuator tube **246** and clamp **260** will be described in detail below.

Cutting jaw **258** includes a blade surface **259** that is angled downwardly towards its distal end to define a fixed acute angle Θ of from about 10 degrees to about 20 degrees with respect to the longitudinal axis of the elongated body portion **224** and to the axis of vibration. Angled blade surface **259** provides good visibility at the surgical site. Preferably, angle Θ is about 12 degrees. It is also contemplated that greater angles can be utilized such as 20 to 30 degrees. Clamp **260** is movable from an open position in which tissue contact member **264** is spaced from blade surface **259** (FIGS. **17** and **18**) to a clamped position in which tissue contact member **264** is in juxtaposed close alignment with blade surface **259** (FIGS. **12** and **13**). In the clamped position, note the positioning of tissue contact member **264** with respect to blade surface **259**. Actuation of the clamp **260** from the open position to the clamped position will be described in detail below.

Referring now to FIGS. **15** and **16**, the handle assembly and the rotation assembly will now be discussed. Housing half-sections **222a** and **222b** define a chamber **276** configured to receive a portion of ultrasonic transducer **230**. Chamber **276** has an opening **278** communicating with the interior of housing **222**. Ultrasonic transducer **230** includes a bore **280** configured to receive proximal end **254** of vibration coupler **250**. In the assembled condition, proximal end **254** extends through opening **278** into bore **280**. Movable handle **236** is pivotally connected between housing half-sections **222a** and **222b** about pivot pin **282** which extends through holes **284** formed in legs **286** of movable handle **236**. A cam slot **288** formed in each leg **286** is

configured to receive a protrusion **290** projecting outwardly from coupling member **298**.

As illustrated in FIG. **16**, coupling member **298** operatively connects movable handle **236** to actuator tube **246** and is preferably formed from molded half-sections **298a** and **298b** to define a throughbore **300** dimensioned to slidably receive the proximal end of vibration coupler **250**. Coupling member **298** has an inner distally located annular groove **302** dimensioned to receive annular flange **248** of actuator tube **246** and an outer proximally located annular groove **304**. Groove **304** is positioned to receive an annular rib **306** formed on the internal wall of a swivel member **308** (FIG. **15**). Swivel member **308** is preferably formed from molded half-sections **308a** and **308b** and permits rotation of coupling member **298** relative to movable handle **236**. Protrusions **290** project outwardly from sidewalls of swivel member **308** and extend through cam slots **288** of movable handle **236**.

Referring again to FIGS. **15** and **16**, rotation knob **234** is preferably formed from molded half-sections **234a** and **234b** and includes a proximal cavity **310** for slidably supporting coupling member **298** and a distal bore **312** dimensioned to receive outer tube **242**. An annular groove **314** formed in bore **312** is positioned to receive annular flange **244** of outer tube **242**. The outer wall of knob **234** has a proximally located annular ring **316** dimensioned to be rotatably received within annular slot **318** formed in opening **320** of housing **222**, and a scalloped surface **322** to facilitate gripping of rotatable knob **234**. Annular ring **316** permits rotation of knob **234** with respect to housing **222** while preventing axial movement with respect thereto. A pair of cylindrical rods **324** extend between half-sections **234a** and **234b** through a rectangular opening **326** formed in coupling member **298**. Rods **324** engage a pair of concave recesses **328** formed in fitting **330** which is fastened about vibration coupler **250**, such that rotation of knob **234** causes rotation of vibration coupler **250** and thus rotation of blade **258** and clamp **260**. Alternately, recesses **328** can be monolithically formed with vibration coupler **250**.

FIGS. **17–21** illustrate ultrasonic instrument **212** with clamp **260** in the open position. The elongated body **224** which includes clamp **260** and blade **258**, and housing **222** which includes handles **228** and **236**, are packaged as an integral unit that requires no assembly by the user prior to use, i.e., the vibration coupler **250**, the clamp **260**, and the blade **258** are non-detachably connected. That is, the user needs only to attach transducer **230** to housing **222** to ready instrument **212** for use. In the open position, movable handle **236** is spaced rearwardly from stationary handle portion **228** and protrusions **290** are positioned in the lower proximal portion of cam slots **288**. At the distal end of ultrasonic instrument **212**, pivot members **266** are positioned near the distal end of guide slots **270** and camming members **272** are positioned in the upper distal portion of cam slots **274**. Tissue contact member **264** of clamp **260** is spaced from blade surface **259** to define a tissue receiving area **332**. The proximal end of tissue receiving area **332** is defined by a pair of tissue receiving stops **335** which are preferably integrally formed with clamp body **262** and extend below blade surface **259**. Preferably, the distal end of blade **258** is rounded to prevent inadvertent damage to tissue during use of instrument **212**. Tissue contact surface **264** is also preferably formed with a concavity **267** to receive tissue therein. Alternatively, the distal end of blade **258** may be formed having any shape which may be suitable to a particular surgical application, i.e., flat, pointed, etc. Moreover, tissue contact surface **264** need not be formed with a concavity but may be flat, angled, etc.

Referring to FIGS. 22–24, when movable handle 236 is pivoted clockwise about pivot member 282 towards stationary handle portion 228, in the direction indicated by arrow “A” in FIG. 22, cam slot 288 engages protrusion 290 of swivel member 308 to advance coupling member 298 distally within cavity 310 of rotation knob 234. Since actuator tube 246 is attached to coupling member 298 by annular flange 248, actuator tube 246 is also advanced distally in the direction indicated by arrow “B” in FIG. 23. Movement of actuator tube 246 distally causes cam slots 274 to move into engagement with camming members 272 to pivot clamp body 262 about pivot members 266, in the direction indicated by arrow “C” in FIG. 23, to move clamp member 262 and tissue contact member 264 into the clamped position. In the clamped position, protrusions 290 are located in a central portion of cam slots 288, pivot members 266 are located near the proximal end of guide slots 270, and camming members 272 are located in the proximal lower portion of cam slots 274.

Elongated body portion 224 can be freely rotated with respect to housing 222 by rotating rotation knob 234. As illustrated in FIG. 25, rotation of knob 234 in the direction indicated by arrow “D” causes rotation of jaw assembly 232 in the direction indicated by arrow “E”. Knob 234 is positioned adjacent housing 222 to facilitate one handed operation of both movable handle 236 and rotation knob 234.

Referring again to FIG. 11, elongated body portion 224 is dimensioned to extend through a trocar assembly 340, and is preferably dimensioned to extend through a 5 mm trocar assembly. During use, elongated body portion 224 is slid through trocar assembly 340 with jaw assembly 232 in the clamped or closed position to a position adjacent to tissue (not shown) to be dissected and/or coagulated. An optical unit (not shown) can also be positioned adjacent the surgical site to facilitate viewing of the procedure. Jaw assembly 232 is opened and tissue to be dissected and/or coagulated is positioned within tissue receiving area 332 (See also FIG. 19). Tissue receiving stops 335 prevent tissue from moving past the proximal end of blade surface 259. Next, jaw assembly 232 is closed to clamp tissue between tissue contact member 264 and blade surface 259. Power is supplied to ultrasonic instrument 212 via control module 214 to initiate vibration of blade 258 to effect dissection and coagulation of tissue. Because of the angle of blade surface 259, the contact pressure applied by blade surface 259 on the tissue being dissected is increased as the force applied to instrument 212 is increased. It is noted that after use, instrument 212 can be autoclaved and used again.

FIG. 26 illustrates another alternate embodiment of the ultrasonic instrument, shown generally as 412. Ultrasonic instrument 412 includes housing 422 and elongated body portion 424 extending distally from housing 422. Housing 422 is preferably formed from molded housing half-sections 422a and 422b and includes a barrel portion 426 having a longitudinal axis aligned with the longitudinal axis of body portion 424 and a stationary handle portion 428 extending obliquely from barrel portion 426. Ultrasonic transducer 430 is supported within and extends from the proximal end of housing 422 and includes a proximal fluted portion 431 configured to engage an attachment device to facilitate attachment and removal of transducer 430 from instrument 412. Jaw assembly 432 is disposed adjacent the distal end of elongated body portion 424 and is actuated by moving movable handle 436 with respect to stationary handle portion 428. Movable handle 436 and stationary handle portion 428 include openings 438 and 440, respectively, to facilitate

gripping and actuation of ultrasonic instrument 412. Elongated body portion 424 is supported within rotatable knob 434 and may be selectively rotated by rotating knob 434 with respect to housing 422 to change the orientation of jaw assembly 432.

FIG. 27 illustrates elongated body portion 424 with parts separated. Elongated body portion 424 includes an outer tube 442 which is preferably cylindrical and has a proximally located annular flange 444 dimensioned to engage rotatable knob 434 (FIG. 26). An elongated actuator tube 446, which is also preferably cylindrical, is configured to be slidably received within outer tube 442 and includes a proximally located annular flange 448 dimensioned to engage coupling member 498 (FIG. 29) which is supported within housing 422 (FIG. 26). Although not shown, it is contemplated that a portion of actuator tube 446 and a portion of outer tube 442 adjacent flange 444 flares outwardly to provide additional clearance for vibration coupler 450. Vibration coupler 450 is dimensioned to extend through elongated actuator tube 446 and includes an enlarged proximal end 452 having a bore (not shown) configured to operatively engage ultrasonic transducer 430. The distal end of actuator tube 446 includes a pair of resilient arms 453 having distally located openings 455. The openings 455 are dimensioned to receive protrusions 461 formed on an adaptor 457. Arms 453 are flexible outwardly and engage adaptor 457. Cutting jaw 458 is monolithically formed with vibration coupler 450. Alternately, cutting jaw 458 and vibration coupler 450 can be formed separately and fastened together using any known connector, e.g., screw threads, friction fit, etc. Although not shown, a plurality of sealing rings can be molded or otherwise attached to the nodal points along vibration coupler 450 to seal between vibration coupler 450 and actuator tube 446.

Referring also to FIGS. 28A–C, a clamp 460 is operably connected to adaptor 457. Clamp 460 preferably includes a pair of longitudinally extending rows of teeth 462 which are spaced from each other a distance which permits cutting jaw 458 to be positioned between the rows of teeth 462. Teeth 462 function to grip tissue when the jaw assembly 432 is in a closed position to prevent tissue from moving with respect to cutting jaw 458 during vibration of the cutting jaw.

Pivot members or pins 466 are formed at the proximal end of clamp 460 and are configured to be received within open ended slots 468 in the distal end of outer tube 442. Slots 468 are open on one side thereof to permit clamp 460 to be retained therein. A longitudinally extending guide slot 470 formed in adaptor 457 is dimensioned to slidably receive pivot pin 466 and permit relative movement between adaptor 457 and clamp 460. A pair of camming members 472 are also formed on clamp 460 and are positioned to be received in cam slots 474 formed in the adaptor 457.

Cutting jaw 458 includes blade surface 459 which is flat and angled downwardly toward its distal end to define a fixed acute angle Θ of from about 10 degrees to about 20 degrees with respect to the longitudinal axis of the elongated body portion 424 and to the axis of vibration. The angled blade surface provides for good visibility at the surgical site. Preferably, angle Θ is about 12 degrees, but greater angles such as 20 to 30 degrees are also envisioned. Alternately, blade surface 459 may be other than flat, e.g., sharpened, rounded, etc.

Clamp 460 is movable relative to cutting jaw 458 from an open position (FIG. 28C) in which tissue contact surface 464 of clamp 460 is spaced from blade surface 459 to a closed or clamped position (FIG. 35) in which tissue contact

surface 464 is in juxtaposed closer alignment with blade surface 459. In the clamped position, note the positioning of tissue contact surface 464 with respect to blade surface 459. Actuation of clamp 460 from the open position to the clamped position will be described in detail below.

Referring to FIGS. 29 and 30, housing half-sections 422a and 422b define a chamber 476 configured to house a portion of ultrasonic transducer 430. Chamber 476 has an opening 478 communicating with the interior of housing 422. Ultrasonic transducer 430 includes a cylindrical stem 480 configured to be received in an opening in proximal end 454 of vibration coupler 450. In the assembled condition, proximal end 454 extends through opening 478 into engagement with cylindrical stem 480. Movable handle 436 is pivotally connected between housing half-sections 422a and 422b about pivot pin members 482 which are monolithically formed with housing half-sections 422a. A cam slot 488 formed in each leg 486 is configured to receive a protrusion 490 projecting outwardly from coupling member 498.

Coupling member 498 operatively connects movable handle 436 to actuator tube 446 and is preferably formed from molded half-sections 498a and 498b to define a throughbore 500 dimensioned to slidably receive the proximal end of vibration coupler 450. Coupling member 498 has an inner distally located annular groove 502 dimensioned to receive annular flange 448 of actuator tube 446 and an outer proximally located annular groove 504 positioned to receive an annular projection 506 formed on the internal wall of swivel member 508. The projection 506 of swivel member 508 is movable through groove 504 to permit relative longitudinal movement between coupling member 498 and swivel member 508. A spring 463 is positioned between coupling member 498 and swivel member 508 to bias the swivel member 508 proximally with respect to coupling member 498. Swivel member 508 is preferably formed from molded half-sections 508a and 508b and permits rotation of coupling member 498 relative to movable handle 436. Protrusions 490 project outwardly from sidewalls of swivel member 508 and extend through cam slots 488 of movable handle 436.

Rotation knob 434 is preferably formed from molded half-sections 434a and 434b and includes a proximal cavity 510 for slidably supporting coupling member 498 and a distal bore 512 dimensioned to receive outer tube 442. An annular groove 514 formed in bore 512 is positioned to receive annular flange 444 of outer tube 442. The outer wall of knob 434 has a proximally located annular ring 516 dimensioned to be rotatably received within annular slot 518 formed in housing 422, and a scalloped surface 522 to facilitate gripping of rotatable knob 434. Annular ring 516 permits rotation of knob 434 with respect to housing 422 while preventing axial movement with respect thereto. A pair of rods or pins 524 extend between half-sections 434a and 434b through a rectangular opening 526 formed in coupling member 498. Rods 524 engage a pair of flattened surfaces 528 formed on vibration coupler 450, such that rotation of knob 434 causes rotation of vibration coupler 450 and thus rotation of blade 458 and clamp 460. Alternately, to provide additional surface contact, instead of pins 524, a C-clip shown generally as 580 in FIG. 31A is provided. C-clip 580 mounted by pins 586 has an opening 582 to receive the vibration coupler 450. The flats of vibration coupler 450 contact the four flat regions 590 of the C-clip 580.

A retainer ring (not shown) may be mounted on ribs 492 of housing 422 (FIG. 32) to provide additional support for actuator tube 446. In this embodiment, tube 446 would extend proximally past ribs 492.

FIGS. 31-34 illustrate ultrasonic instrument 412 with clamp 460 in the open position. The elongated body 424 which includes clamp 460 and blade 458, and housing 422 which includes handles 428 and 436, are packaged as an integral unit that requires no assembly by the user prior to use, i.e., vibration coupler 450, clamp 460, and blade 458 are non-detachably connected. That is, the user needs only to attach transducer 430 to housing 422 to ready instrument 412 for use. In the open position, movable handle 436 is spaced rearwardly from stationary handle portion 428 and protrusions 490 are positioned in the lower proximal portion of cam slots 488. At the distal end of ultrasonic instrument 412, pivot members 466 are positioned near the distal end of guide slots 470 and camming members 472 are positioned in the upper distal portion of cam slots 474. Tissue contact surface 464 of clamp 460 is spaced from blade surface 459 to define a tissue receiving area 532. The proximal end of tissue receiving area 532 is defined by a pair of tissue receiving stops 535 which are preferably integrally formed with clamp 460 and extend below blade surface 459. Preferably, the distal end of blade 458 is devoid of sharp edges which may cause inadvertent damage to tissue during use of instrument 412. Alternately, the distal end of blade 458 may be formed having any shape which may be suitable to a particular surgical application, i.e., flat, pointed, etc.

Referring to FIGS. 35 and 36, when movable handle 436 is pivoted clockwise about pivot member 482 towards stationary handle portion 428, in the direction indicated by arrow "G" in FIG. 35, cam slot 488 engages protrusion 490 of swivel member 508 to advance coupling member 498 distally within cavity 510 of rotation knob 434. Since actuator tube 446 is attached to coupling member 498 by annular flange 448, actuator tube 446 is also advanced distally in the direction indicated by arrow "H" in FIG. 36. Movement of actuator tube 446 distally causes cam slots 474 to move into engagement with camming members 472 to pivot clamp body 462 about pivot members 466, in the direction indicated by arrow "I" in FIG. 36, to move clamp member 462 and tissue contact member 464 into the clamped position. Spring 463 prevents over clamping of tissue by permitting relative 20 movement between swivel member 508 and coupling member 498 after a predetermined clamping pressure has been applied against blade 458. In the clamped position, protrusions 490 are located in a central portion of cam slots 488, pivot members 466 are located near the proximal end of guide slots 470, and camming members 472 are located in the proximal lower portion of cam slots 474.

Elongated body portion 424 can be freely rotated with respect to housing 422 by rotating rotation knob 434. Rotation of knob 434 in the direction indicated by arrow "J" causes rotation of jaw assembly 432 in the direction indicated by arrow "K". Knob 434 is positioned adjacent housing 422 to facilitate one handed operation of both movable handle 436 and rotation knob 434.

Referring now to FIG. 37, an alternate embodiment of the ultrasonic transducer is shown generally as 630. Ultrasonic transducer 630 includes a housing 631 having a proximal housing portion 632 and a distal housing portion 634. Proximal housing portion 632 has a scalloped section 636 adjacent its proximal end and distal housing portion 634 has a radial portion 635 that extends inwardly to partially cover transducer horn 638. Transducer horn 638 includes a shoulder portion 637 positioned adjacent to radial portion 635 of distal housing portion 634 to define a recess 651 for receiving a washer 639. Washer 639 functions to seal the space between radial portion 635 and transducer horn 638 and, to

prevent transducer horn **638** from longitudinal contact with distal housing portion **634**. Shoulder portion **637** of transducer horn **638** does contact an inner wall of distal housing portion **634** to assist in maintaining the longitudinal alignment of transducer horn **638** within housing **631**. The distal end of transducer horn **638** includes a threaded bore **644** dimensioned to engage a reduced diameter portion of vibration coupler **650**. A pair of spacers **640** are positioned between transducer horn **638** and distal housing portion **634**. Each spacer **640** includes an annular flange **648** which is sonically welded and hermetically sealed between proximal and distal housing portions **632** and **634**. The proximal end of each spacer **640** engages an O-ring of a pair of O-rings to compress the O-rings to provide a seal between distal housing portion **634** and transducer horn **638** and to provide radial support for transducer horn **638**. The spacer O-ring combination further maintains transducer horn **638** in a position to compress washer **639** in recess **641**. Piezoelectric crystals **650** are secured in contact with the proximal end of transducer horn **638** by a backing plate **652** and a screw (not shown) which is inserted through an opening **656** in backing plate **652** into threaded bore **658** formed in the proximal end of transducer horn **638**. Wires (not shown) from crystals **650** extend to a connector **659** which may be threadably received in an opening **661** in proximal housing portion **632**.

FIGS. **38A** and **38B** illustrate a torque wrench assembly shown generally as **670**. Torque wrench assembly **670** includes outer housing **672** and inner drive member **674**. Inner drive member **674** has an opening **675** having an inner scalloped wall **677** configured to matingly engage scalloped section **636** of housing **631**. Inner drive member **674** also includes a projection or bump **676** (see FIG. **38D**) which extends into a cylindrical recess **678** defined between inner driver member **674** and outer housing **672**. A cam member **682** is positioned within recess **678** and is maintained in contact with bump **676** by a urethane ring and washer assembly **682**. Cam member **682** includes projections **685** which fit between inner ribs of outer housing **672**. Cam member **682** has an end surface having a series of sloped surfaces **687** and shoulders **689** (FIG. **38C**). In use, when opening **675** is slid over scalloped section **636** of housing **631** and outer housing **672** of torque wrench assembly **670** is gripped and rotated, cam member **682** is also rotated. The sloped surfaces **687** on cam member **682** slide over bump **676** until a respective shoulder engages bump **676**, thereby rotating inner driver member **674** to consequently rotate transducer assembly **630**. Inner driver **674** member will rotate with cam member **682** until the torque necessary to rotate transducer assembly **630** with respect to the vibration coupler (not shown) exceeds the force required to force the shoulders **689** over bump **676**.

It will be understood that various modifications may be made to the embodiments herein. For example, vibration coupler **50** and blade **58** may be monolithically formed or attached using structure other than screw threads and the proximal end of ultrasonic transducer **630** need not have a scalloped configuration, but rather may be configured for engagement with any suitable torque wrench assembly. Further, the elongated body portion of the device need not be dimensioned to extend through a 5 mm trocar assembly, but rather may be dimensioned to extend through any size trocar assembly, e.g., 10 mm, 12 mm, etc. Therefore, the above description should not be construed as limiting, but merely as exemplifications of preferred embodiments. Those skilled in the art will envision other modifications within the scope and spirit of the claims appended hereto.

What is claimed is:

1. An ultrasonic surgical instrument for cutting body tissue comprising:
 - a housing including a first handle and a second handle movable with respect to the first handle;
 - an elongated outer tube extending from the housing, the elongated outer tube defining a longitudinal axis and having proximal and distal portions and a lumen extending therethrough;
 - a clamp member extending distally of the distal portion of the outer tube and pivotable between an open position and a clamped position by movement of the second handle between first and second positions, the clamp member including a tissue clamping surface;
 - an elongated actuator tube defining a central longitudinal axis, having a lumen extending therethrough and being positioned within the lumen of the outer tube, the actuator tube being longitudinally slidable within the lumen of the outer tube to pivot the clamp member between the open and clamped positions;
 - an elongated vibration coupler defining a longitudinal axis and positioned within the lumen of the actuator tube, the vibration coupler adapted to be operably connected to an ultrasonic generator for vibration in response to actuation of the ultrasonic generator and including a blade member extending therefrom, the blade member including a tissue contacting surface, the clamp member pivoting with respect to the tissue contacting surface to clamp tissue between the clamping surface of the clamp member and the tissue contacting surface of the blade member; and
 - a rotation knob positioned adjacent the housing, the vibration coupler, outer tube and actuator tube being operatively connected to the rotation knob, the rotation knob rotatable to rotate the outer tube, actuator tube and vibration coupler about their respective longitudinal axes to change their orientation with respect to body tissue.
2. The surgical instrument of claim 1, wherein the tissue contacting surface of the blade member is planar.
3. The surgical instrument of claim 1, wherein the tissue contacting surface of the blade member is linear.
4. The surgical instrument of claim 1, wherein the blade member tapers in height toward its distal end.
5. The surgical instrument of claim 1, wherein the clamp member includes a pair of pivot pins to pivot the clamp member between the open and clamped positions.
6. The surgical instrument of claim 1, wherein the vibration coupler is non-detachably connected to the rotation knob by a pin.
7. The surgical instrument of claim 2, further comprising a biasing mechanism for biasing the clamp member to the open position.
8. The surgical instrument of claim 1, wherein the actuator tube is slidable in a distal direction to move the clamp member to the clamped position.
9. The surgical instrument of claim 1, further comprising a transducer removably connected to the housing.
10. The surgical instrument of claim 1, further comprising at least one ring positioned on the vibration coupler to seal the flow of fluids between the vibration coupler and the actuator tube.
11. The surgical instrument of claim 1, wherein the clamp member includes a pair of pivot pins and a pair of camming members spaced from the pivot pins.
12. The surgical instrument of claim 1, wherein the actuator tube includes a pair of slots engagable with a pair of camming members of the clamp member.